

# ELOK

## 6-Series User Manual



## Summary Check List:

- ☐ 1. Crop out done as per template.
- ☐ 2. Check rubber gasket installed correctly with lugs pressed in tight. So proper seal around backplate edge is created.
- ☐ 3. Ensure sprung pin is installed, securing spindle to the spindle hub.
- ☐ 4. Ensure screw casing bolts and through bolts tightened.
- ☐ 5. Ensure power cable wire installed correctly and not bent or crimped in door.
- ☐ 6. Check batteries installed in correct position.

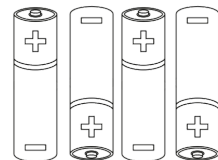
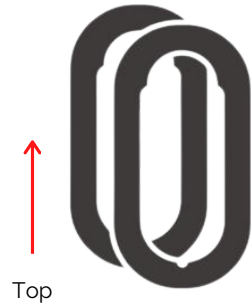

Professionally Installed by: \_\_\_\_\_

PIN-Code: \_\_\_\_\_

Date: \_\_\_\_/\_\_\_\_/\_\_\_\_

## Please Note:

- Keep the included mechanical keys in a convenient place such as an Elements Hardware 1236-BLK Key Safe
- Replace the batteries when they have low voltage
  - **Use Alkaline 1.5v Batteries Only**
- Read this User Manual carefully before installing your 6-Series Smart Lock



1236-BLK Shown:

## Contents Page

<b>Pg 5.</b>	6-Series Body Dimensions
<b>Pg 6.</b>	Latch Options
<b>Pg 7.</b>	6-Series Packing List
<b>Pg 8.</b>	6-Series Specifications
<b>Pg 9.</b>	Adjusting the Handing
<b>Pg 10-11.</b>	Installation
<b>Pg 12.</b>	Unlocking E-LOK 6-Series with Key
<b>Pg 13.</b>	Set-Up E-LOK App
<b>Pg 14.</b>	Battery Percentage + Lockset Clock
<b>Pg 15.</b>	Bluetooth Unlock + PIN Code Management
<b>Pg 16.</b>	RFID Card Management + Remote
<b>Pg 17.</b>	Authorized Admin + e-Key Management
<b>Pg 18.</b>	Passage Mode
<b>Pg 19.</b>	Admin Passcode + Records
<b>Pg 20.</b>	Auto Lock + Lock Sound
<b>Pg 21.</b>	Import From Another Lock + Lock Groups
<b>Pg 22.</b>	Proximity Touch + Reset Button Control
<b>Pg 23.</b>	Transfer Ownership
<b>Pg 24.</b>	Factory Reset + Removing E-LOK from App
<b>Pg 25.</b>	E-LOK Gateway Info + Setup
<b>Pg 26.</b>	E-LOK Gateway Setup Continued
<b>Pg 27.</b>	Remote Unlock + Power Saving Mode
<b>Pg 28.</b>	E-LOK Gateway Reset + Transfer
<b>Pg 29.</b>	Maintenance Guidelines
<b>Pg 30.</b>	Important Notes + Contact Us



## 6-Series Body Dimensions

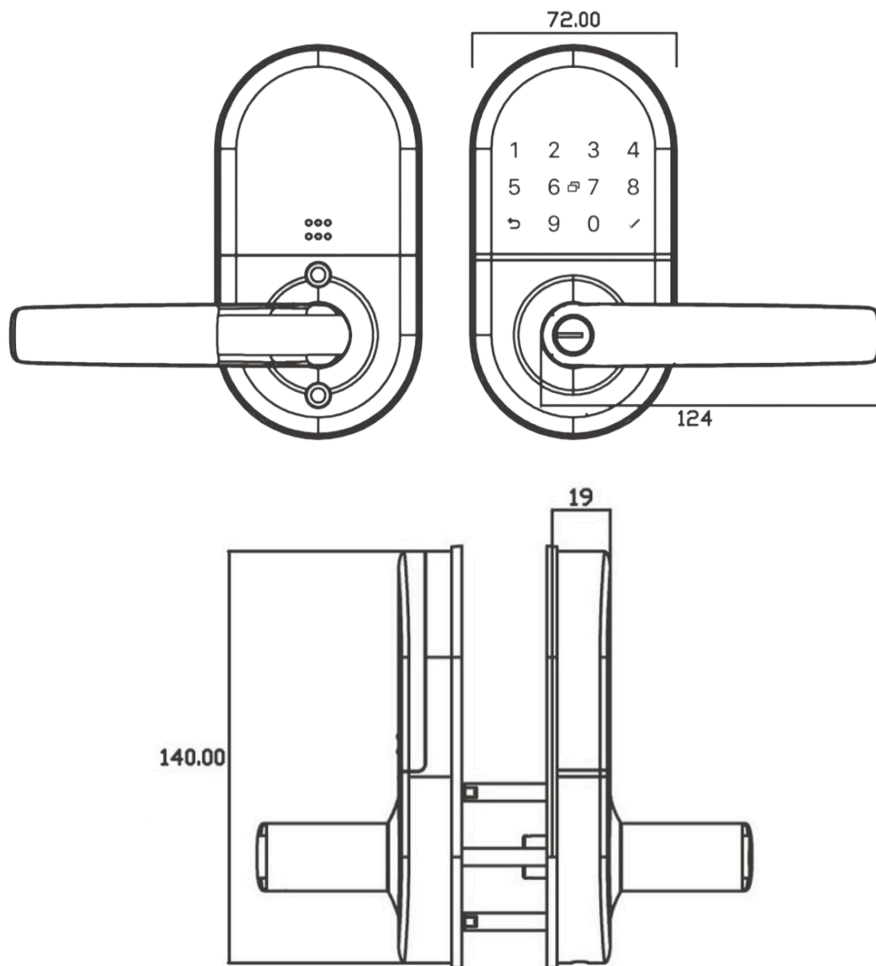

- Top, E-LOK 605 body and lever dimension
  - Bottom, side view body and lever projection
- All measurements in millimeters

## Latch Options

### **Back set:**

Adjustable 60mm-70mm Backset

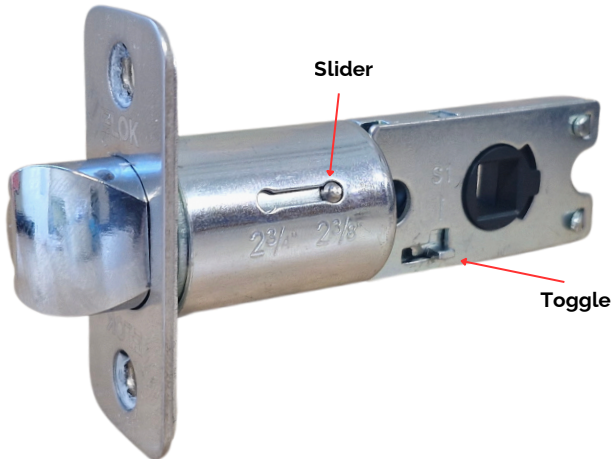

Adjustable backset to 60mm or 70mm to fit the most common size doors in New Zealand. To change to 70mm Backset, hold the toggle up while sliding the slider to the left the whole way across.

This latch opens when the handle is pulled down, or pushed up, when the E-LOK is unlocked. This is because the spindle engages with the E-LOK when the E-LOK is unlocked, meaning it can be opened.

When the E-LOK is locked, the spindle disengages with the E-LOK, so it cannot be opened.

**Note:** Please ensure the slider is at exactly 60mm or 70mm, and not in between.

## 6-Series Packing List

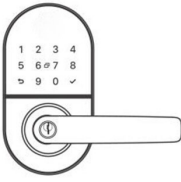

Front Panel  
QTY 1

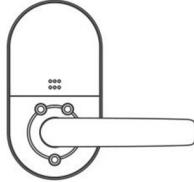

Back Panel  
QTY 1

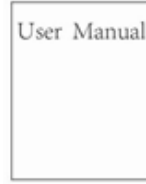

User Manual  
QTY 1

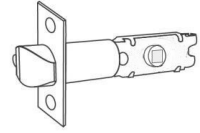

605 Latch  
QTY 1

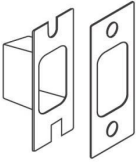

Strike & Strike  
Box  
QTY 2



RFID Card  
QTY 3



Mechanical Key  
QTY 2



Gasket  
QTY 2

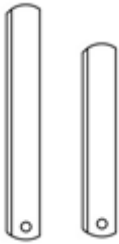

Spindle (2 Sizes)  
QTY 2

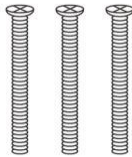

Screw A (2 Sizes)  
QTY 6



Allen Wrench  
QTY 1

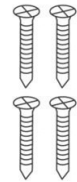

Wood Screws  
QTY 4

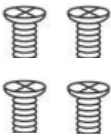

Alum Screws  
QTY 4



Screw Casing  
(2 Sizes)  
QTY 6



Positioning  
Column  
QTY 2



Reset Pin  
QTY 1

## Specifications

<b>Product Name:</b>	E-LOK 6-Series Smart Lock
<b>Operating Application:</b>	E-LOK App
<b>Finish:</b>	Black or Silver
<b>Unlock Methods:</b>	PIN Code RFID Card E-LOK App Mechanical Key
<b>Max Num. Locks on App:</b>	Unlimited
<b>Max Num. PIN Codes:</b>	150 PIN Codes
<b>Max Num. RFID Cards:</b>	200 RFID Cards
<b>Batteries:</b>	6V (4 x 1.5v AA Batteries) - Must be Alkaline
<b>Operating Temp:</b>	— 10°C - 55°C
<b>Operating Humidity:</b>	0% - 95%
<b>Suitable Door Thickness:</b>	35mm - 65mm
<b>Suitable Door Types:</b>	Aluminium Door, Wooden Door
<b>Product Size (Body only):</b>	140mm(H) x 72mm(W) x 19mm(D)
<b>Product Size (Lever):</b>	124mm(L)
<b>Available Latch Sizes:</b>	60mm and 70mm Back Set
<b>6-Series Residential Warranty:</b>	2 Year Mechanical and Electrical
<b>E-LOK Gateway Warranty:</b>	2 Year
<b>Weather Rating:</b>	Exterior Rated IP 55

## Adjusting The Handing

### Steps to change the handing on E-LOK 6-Series:

Note: Adjust the handle according to the direction you open the door.

#### For Exterior Assembly:

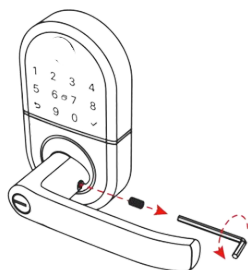

1. Loosen the screw with the 3mm Allen Wrench

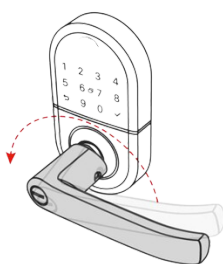

2. Adjust the door handle direction

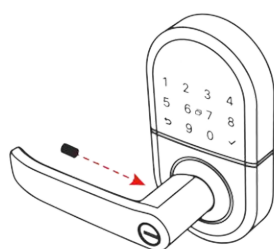

3. Tighten the screw after adjusting the handle direction.

#### For Interior Assembly:

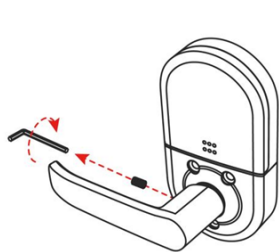

1. Loosen the screw

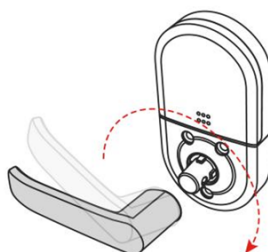

2. Lift off door handle, and adjust the door handle direction

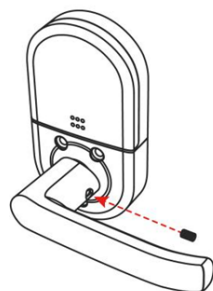

3. Tighten the screw after adjusting the handle direction.

## Installation

### Step 1.

Using the included template, cut holes into door for the Hardware and Strike.

### Step 2.

Insert latch and screw in., then install the strike/strike box. Please note your E-LOK 6-Series comes with screws to suit both wooden and aluminum doors.

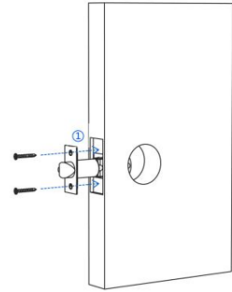

### Step 3.

Install the Gasket on the exterior panel.

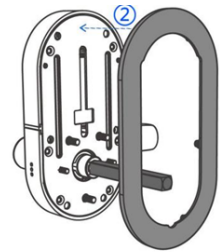

### Step 4.

Install spindle into spindle hub. Ensure sprung pin is seated correctly.



### Step 5.

Install 2 positioning columns.

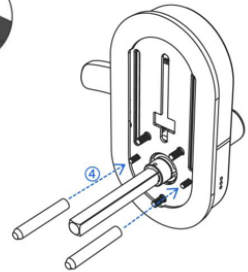

### Step 6.

Install 3 screw casings (choose size depending on door thickness),

### Step 7.

Ensuring there is sufficient room for cable, align Exterior handle with holes drilled (a hole may need drilled for cable)

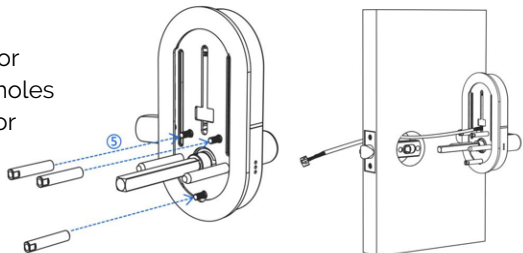

## Installation

### Step 8.

Install gasket on interior panel.

### Step 9.

Connect exterior cable to interior. Align Interior handle with spindle and fixing hole, and fix handles together with screw A (choose size depending on door thickness).

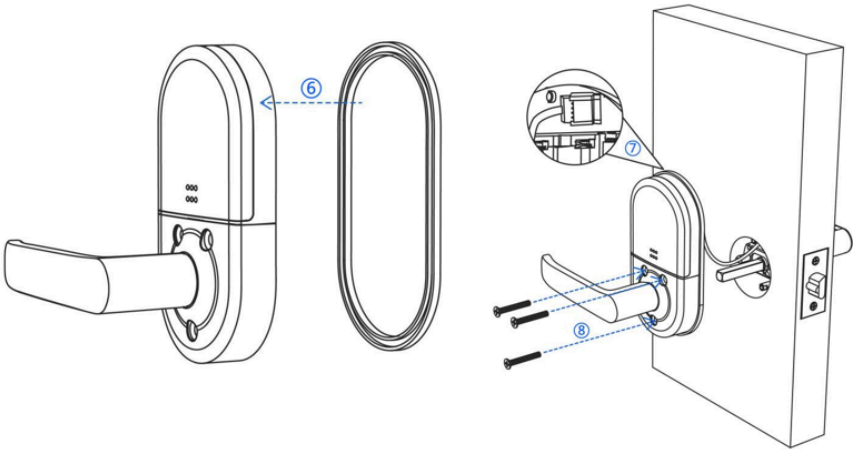

### Step 10.

Slide up battery cover and install batteries. Slide Battery cover back into place.

Now your E-LOK 6-Series Smart Lock is ready to set up.

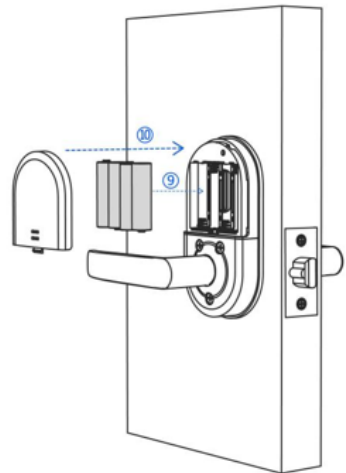

## Unlocking E-LOK 6-Series with Key

The 6-Series Smart Lock has a mechanical key override to unlock it. Barrel location is on the lever like a standard key Leverset. Insert one of the included keys, turn and pull handle down to unlock.

The USB-C port beside it can be used to power up the Smart Lock if the batteries run flat.

Please see the below diagram showing the location of the mechanical key barrel and USB-C port.

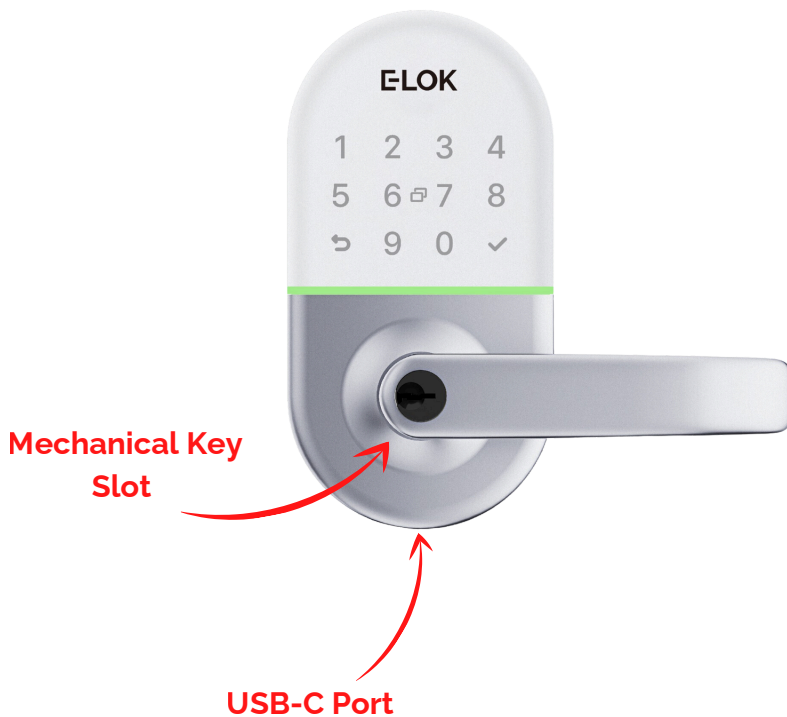



## Set-Up E-LOK App

Get the E-LOK App



The Register screen features a back arrow at the top left. Below the title, there are two tabs: 'Email' (selected) and 'Phone'. The form includes fields for 'Country/Region' (set to 'New Zealand'), 'Enter your Email', 'Password' (with a strength indicator), and 'Confirm Password'. A note specifies: 'Your password must have 8-20 characters, and include a minimum of two types of numbers, letters and symbols'. There is a 'Verification Code' field and a 'Get Code' button. At the bottom, a 'Register' button is present, along with a checkbox for 'I've read and agreed User Terms Privacy Policy'.

1. Register an account with E-LOK using either phone number or email.

The Login screen has a back arrow and a 'Register' link at the top right. The E-LOK logo is centered. Below it, there are fields for 'Phone Number or Email' and 'Password'. A checkbox for 'I've read and agreed User Terms Privacy Policy' is checked. A 'Login' button is at the bottom, with a 'Forgot Password?' link below it.

2. Login to your account.

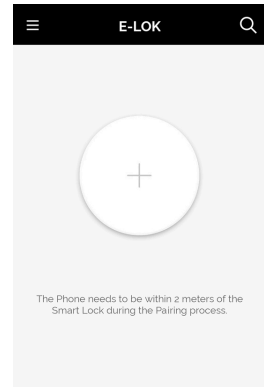

3. Ensure E-LOK smart lock is on and Bluetooth enabled on phone, connect to lock. Tap Keypad & select '+' sign to pair

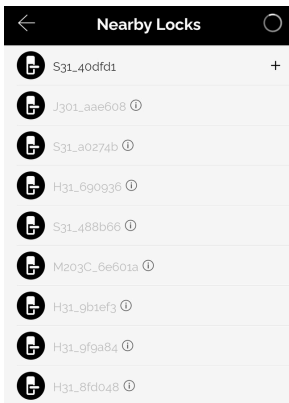

4. Select your E-LOK smart lock. Note it will appear under a serial number which is usually at the top in black.

The 'Add Lock' screen shows a back arrow and the title 'Add Lock'. It displays the message 'PAIRED Successfully. Please ASSIGN a Name for it'. Below this is a text input field labeled 'Enter a Name' and an 'OK' button at the bottom.

5. Rename your E-LOK smart lock to your preference.

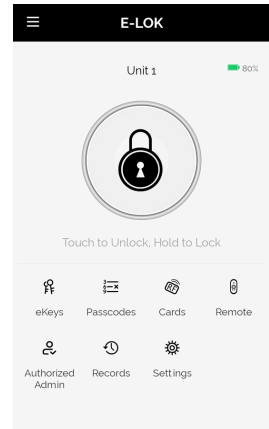

6. View your E-LOK lock management page.

## Battery Percentage + Lockset Clock

### Check Battery Percentage:

E-LOK App allows you to check the battery percentage of your E-LOK in two easy ways. In the lock select page, the app will give you a percentage overview to the nearest 5%. You can also find a more accurate battery level in the settings of the Smart Lock. Select 'Settings', select 'Basics' and then view your battery percentage. **Remember to update this frequently (select 'Battery' and 'Update' while within Bluetooth range).**

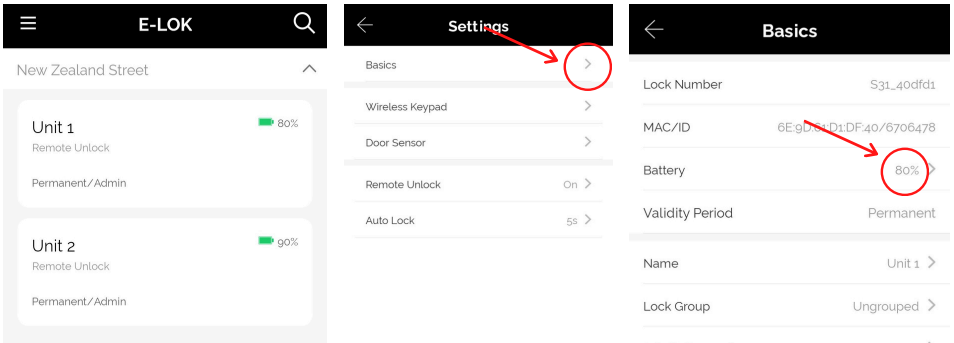

### E-LOK Lockset Clock:

Celebrate you E-LOK's Lockset Clock. Select 'Settings' then 'Lock Clock'. Select 'Calibrate Time'. Your E-LOK Smart Lock will communicate with the E-LOK App and set the correct time. This will ensure that operation specifications and unlock records are accurate.

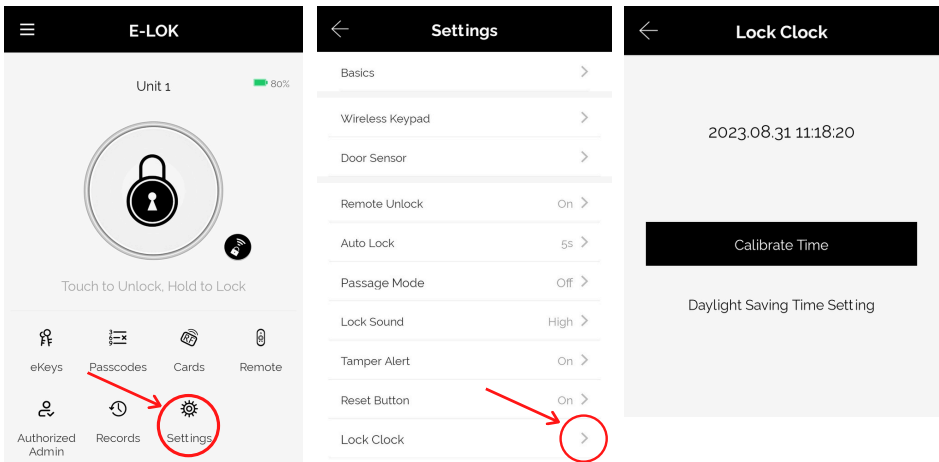

## Bluetooth Unlock + PIN Code Management

### Bluetooth Unlock:

Once the E-LOK is connected to the App you can Lock and unlock the E-LOK using the App. Open the lock management page and select the 'lock' icon, this will unlock your Smart Lock via Bluetooth. Hold the 'lock' icon and your smart lock will lock via Bluetooth.

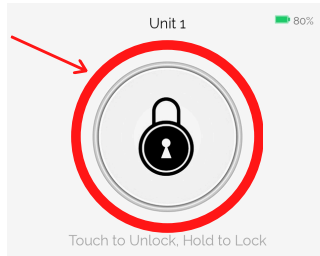

### PIN Code Management:

E-LOK App allows you to set 200 unique PIN Codes. You can set a range of different types of PIN Code. We recommend using the 'Custom' setting to create yours. Set it to permanent, name it and set your preferred sequence. (4-9 digits).

Recurring PIN Code allows you to set a PIN Code that only works on certain times and days ex. Saturday and Sunday from 10:00 - 20:00. The app also allows for one-timed and timed PIN Codes. For security reasons codes will time out if not used within a specified period - see the App for more details.

**Using your Pin Code:** enter your pin code followed by '✓' to unlock your E-LOK. E-LOKs have an inbuilt security function which allows for additional numbers to be entered as long as your pin is entered in sequence, ex. pin '1234' entered '5612348'.

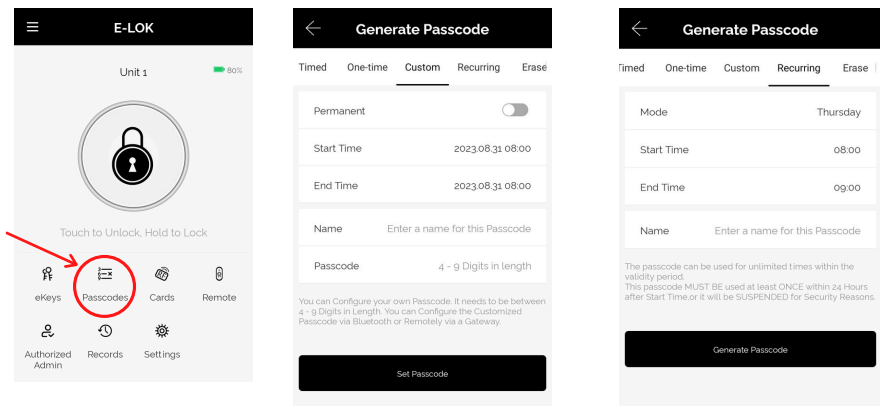

## RFID Card Management + Remote

### RFID Card Management:

E-LOK App allows you to store 200 unique RFID Cards. To set up one of the three FOBs included with your E-LOK 6-Series Smart Lock, select 'Cards' on the lock management page, select 'Add Card'. Choose Timed, Permanent, or Recurring, and name them individually.

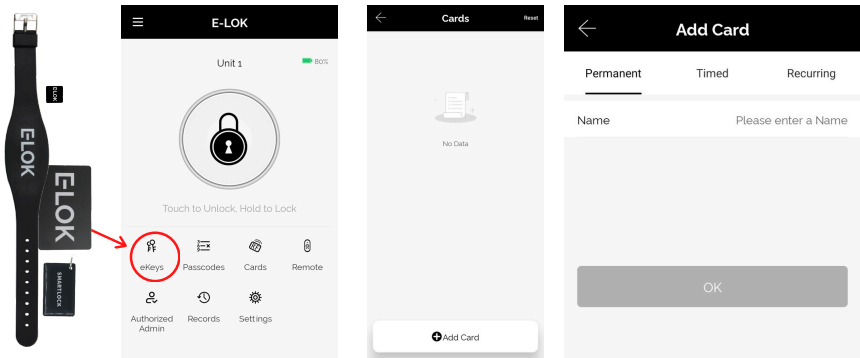

### E-LOK Remote:

E-LOK's have a function where you can connect a remote to the lock, so you can unlock and lock it via bluetooth.

First, go to 'Remote', on the E-LOK management page. Next choose permanent, timed, or recurring. Then, select 'add remote'. Follow the instructions on the screen to add the remote to your E-LOK.

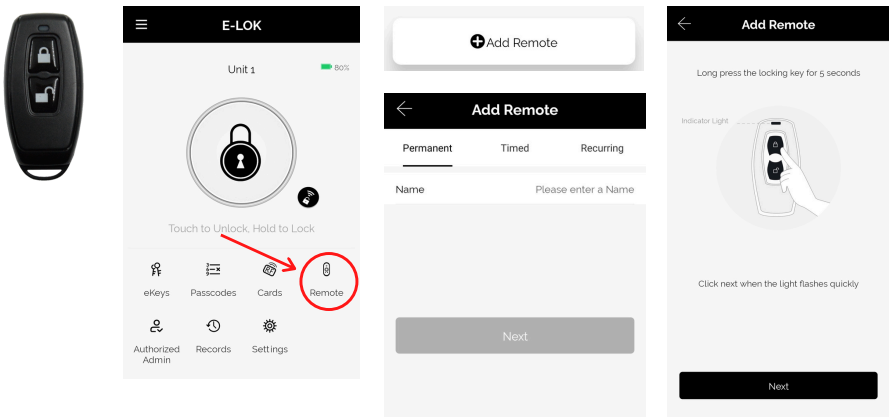

## Authorized Admin + e-Key Management

### Authorized Admin:

Authorized Admin allows another person with an E-LOK App to access your E-LOK, they can add, change or delete unlock codes set by themselves. Select 'Authorized Admin' in the E-LOK management home page. Then Select 'create admin', **Please note: Send this to the phone number or email associated with the receivers E-LOK App account.**

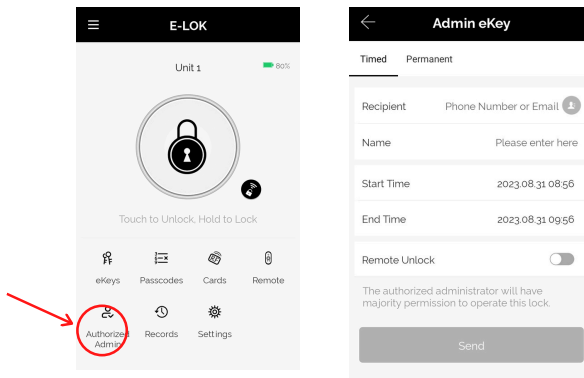

### e-Key Management:

An e-Key allows another person with an E-LOK App to unlock/lock your E-LOK 10-Series via the App; e-Keys can be setup as permanent or with parameters. Select the 'eKeys' on the lock management page. Then select 'send eKey'.

**Please note: Send this to the phone number or email associated with the receivers E-LOK App account.**

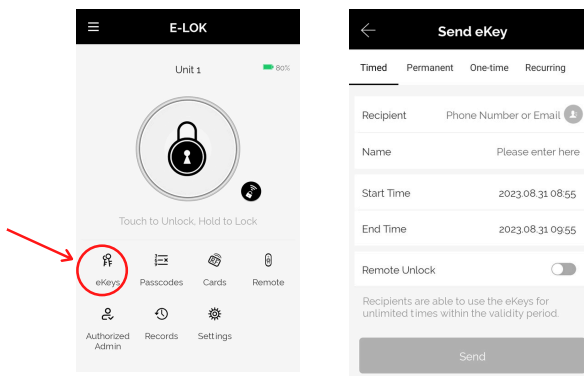

## Passage Mode:

### Passage Mode:

Set parameters to keep the E-LOK unlocked during specified periods. Select 'Settings', Select 'Passage Mode', Choose the days and hours you wish the E-LOK to be open (ex. Mon - Fri 9:00 - 17:00). From when it is unlock electronically during these hours your E-LOK will say unlocked. The 'Auto Lock' function will lock the E-LOK at the specified time.

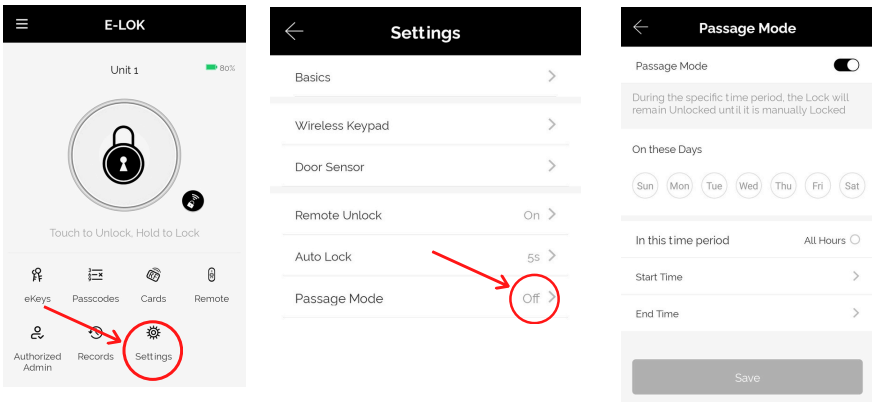

### Manual Passage Mode:

E-LOK's can be put into Passage Mode manually by unlocking the E-LOK using pin number etc. then entering '123✓' on the Keypad.

### Locking your E-LOK in Passage Mode:

#### Method 1.

Open up the E-LOK App, long press 'Lock' button on E-LOK app.

#### Method 2.

Once exited, long press '✓' Key on pinpad.

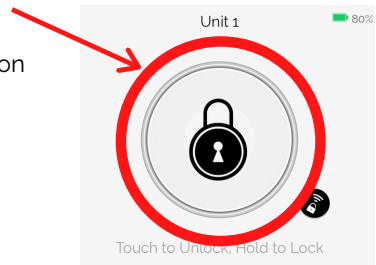

## Admin Passcode + Records

### Admin Passcode:

E-LOK comes with an admin passcode. To view this select 'Settings' on the lock management page, select 'Basics' and then select 'Admin Passcode'.

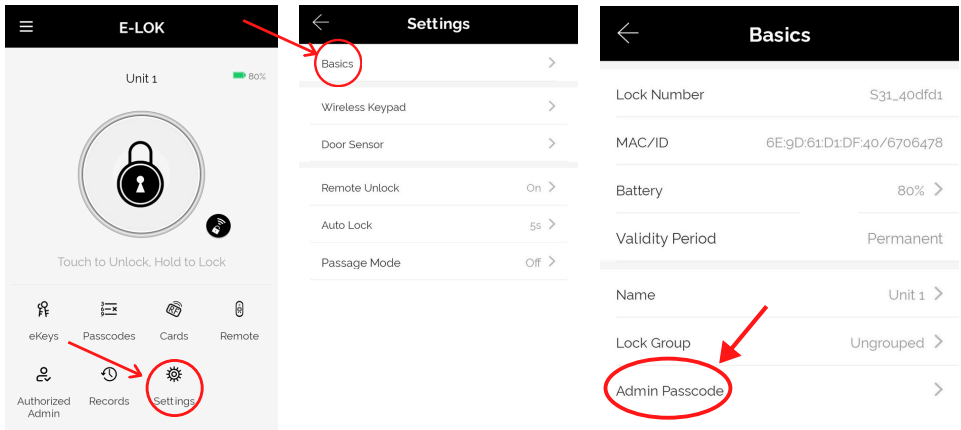

### Unlock Records:

E-LOK App records which passcodes were used to unlock and lock the E-LOK and when. You can view these records by going into the 'Records' menu on the lock management page. Only a certain period of records can be retained, you can export these to a spreadsheet to keep historical records and clear or refresh your records to keep things current.

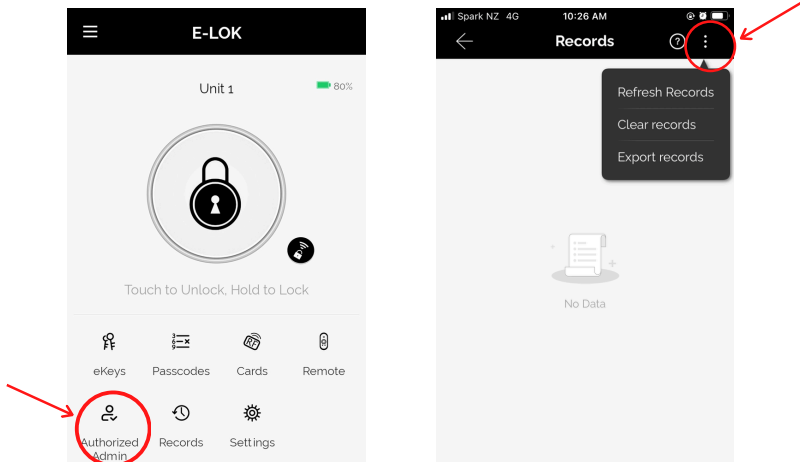

## Auto Lock + Lock Sound

### Auto Lock:

This function automatically disengages the exterior handle. The E-LOK App allows you to control the auto lock timer on the Smart Lock, you can adjust the time allowed or turn this function off. Select 'Settings'. Select 'Auto Lock'. Adjust setting to suit. **Please note if Auto Lock is off Passage Mode will not lock automatically.**

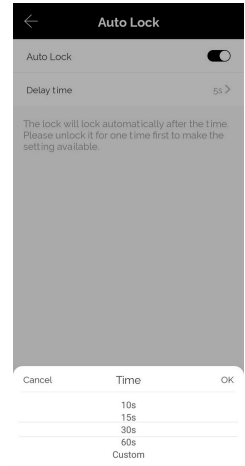
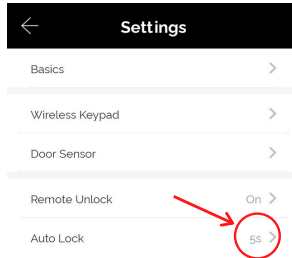
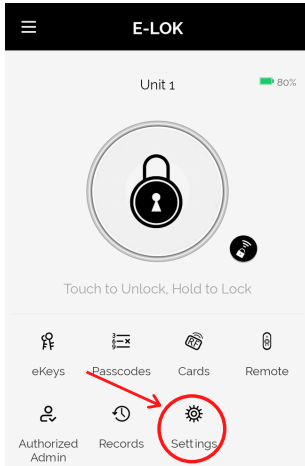

### Lock Sound:

The Lock Sound function lets you enable or disable the sound and control the volume. By default Lock Sound is enabled and on high. Select 'Settings'. Select 'Lock Sound'.

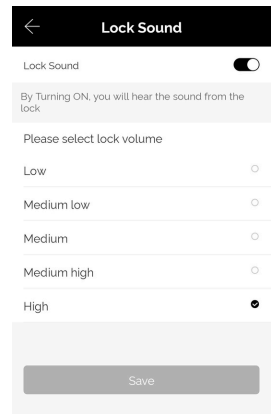
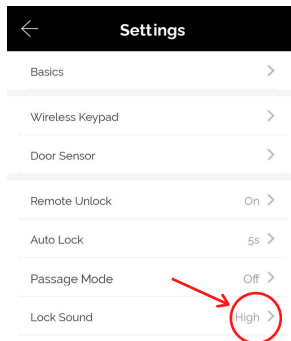
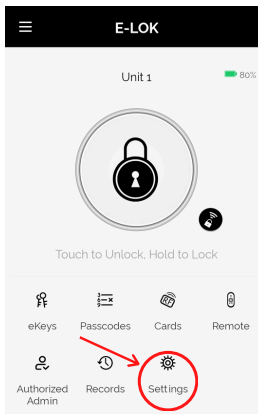



## Import From Another Lock + Lock Groups

### Import from another E-LOK Smart Lock:

This feature allows you to sync PIN-Codes and RFID Cards between E-LOK Smart locks. Select 'Settings'. Select 'Import from another lock'. Select the lock you would like to import from.

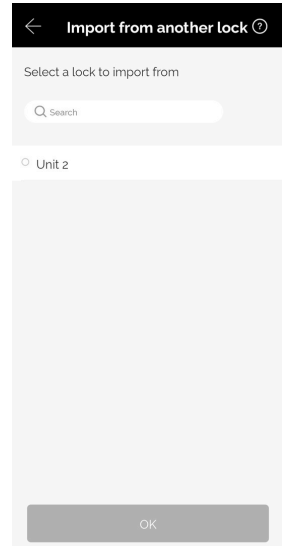
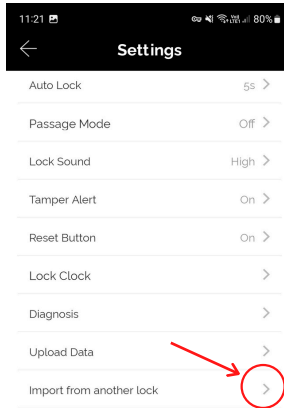
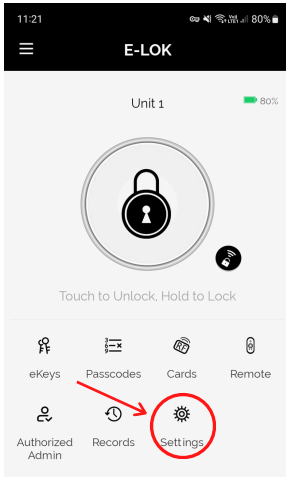

### Lock Groups:

You can link E-LOK Smart Locks together in lock groups. First create a lock group in the main settings, then link a Smart Lock to the group in each individual lock settings, select 'Settings' - 'Basics' - 'Lock Group'. View lock groups in the select page. This function allows you to keep the App's home screen tidy by grouping locks from the same site etc.

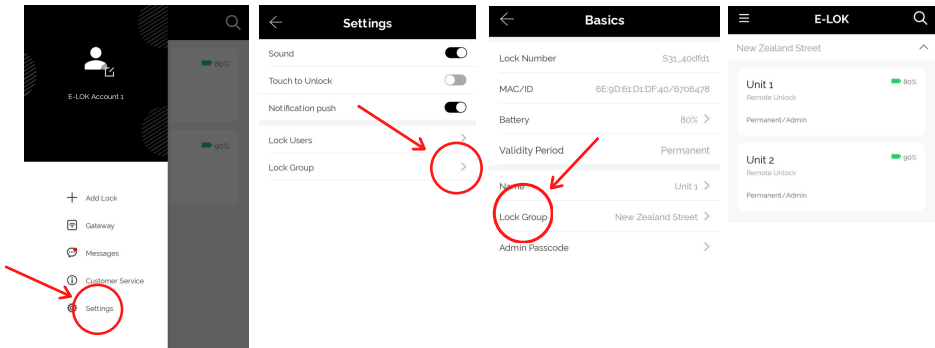

## Proximity Touch + Reset Button Control

### Proximity Touch to Unlock:

When this feature is enabled it lets you unlock your E-LOK Smart Lock just by pressing any number on the Keypad whilst the app is open. To use this feature, go to the App menu and select 'Settings'. Then enable 'Touch to Unlock'.

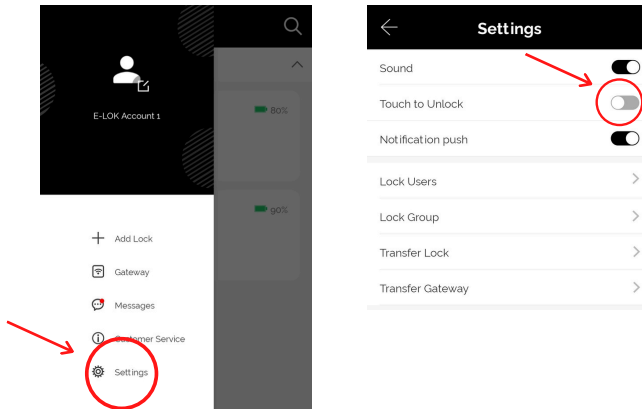

### Reset Button Control:

You can disable the Manual Reset button on your E-LOK by deselecting 'Reset Button' in the E-LOK's App settings. Select 'Settings'. Select 'Reset Button'. Adjust setting to preference. This feature works great on E-LOK's installed on Airbnb's, rentals etc. **Please note that while disabled only the E-LOK's 'Master Admin' can factory reset the lock.**

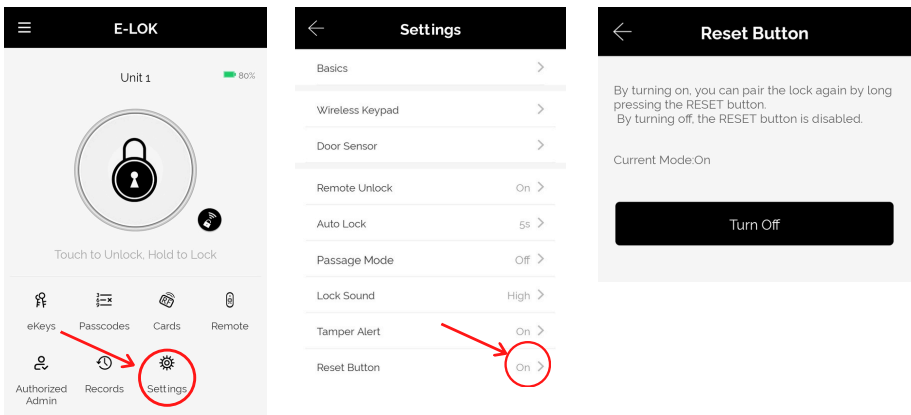

## Transfer Ownership

### Transfer Lockset Ownership:

This feature allows the 'Master Admin' to be transferred to another E-LOK App account holder, along with all the settings, pins etc. saved to that E-LOK. To Transfer Ownership open App menu, select 'Settings'. select 'Transfer Lock'. Select the lock you want to transfer. Enter the receivers phone number or email (**whichever their E-LOK App account is setup under**) and select 'Next'.

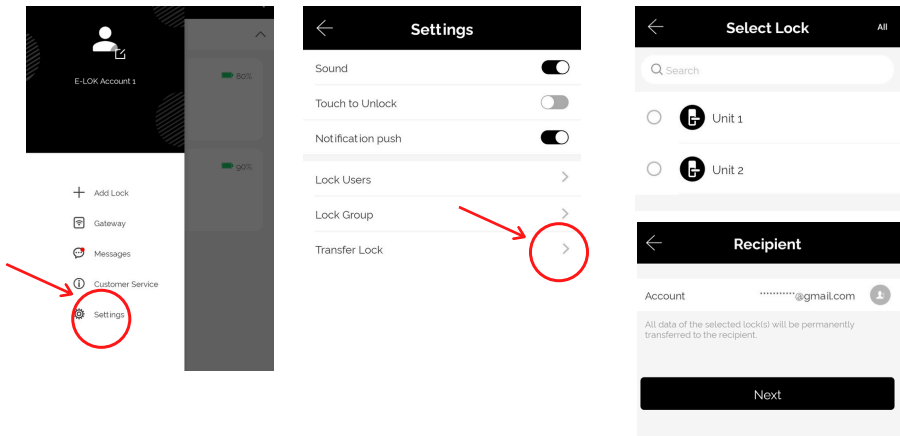

## Factory Reset + Removing E-LOK from App

### Factory Reset via E-LOK App: (Master Admin only)

In the lock Management Page and within Bluetooth range of the E-LOK, Select 'Settings'. Select 'Delete' and input your E-LOK App password. The E-LOK is now Factory Reset.

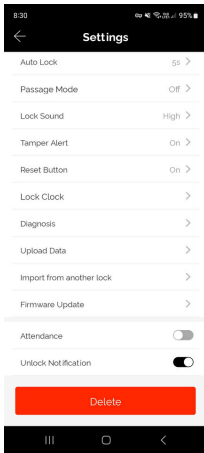

### Manual Reset:

Remove battery cover and hold the reset button in the battery case until you hear "Please input initialization passcode". Input code '000✓' on the keypad. E-LOK will then state "Deleting administrator successful".

**Please Note:** if the 'Reset Button' has been deactivated the E-LOK cannot be 'Manual Reset'.

Reset button



### Removing Manual Reset/Replaced E-LOKs from App:

To remove reset locks from the E-LOK app, go to the app menu, select 'Settings'. Select 'Transfer Lock(s)', select lock. Select 'Next', select 'Remove the Malfunction lock' at the bottom of the page.

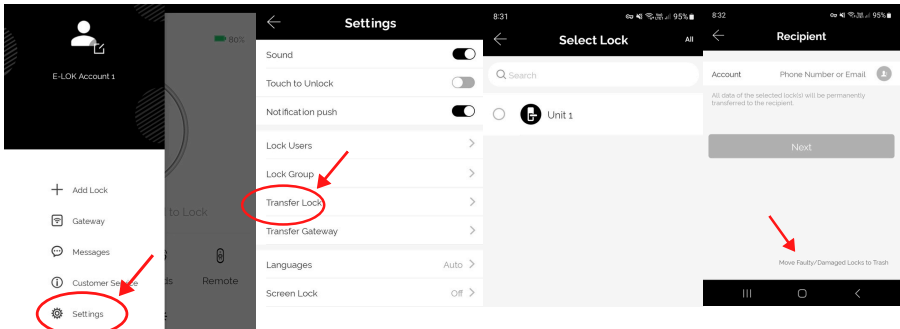

## E-LOK Gateway Info + Setup

(Optional Add-On)

The E-LOK Gateway connects your E-LOK to Wi-Fi via Bluetooth, allowing the transfer of information and commands to your E-LOK via Wi-Fi.

Please note: only the **'Master Admin'** can set-up an E-LOK Gateway to a Smart Lock.

E-LOK Gateway should be plugged in via the included USB-C cable.

It must be:

- Near a Wi-Fi router
- Near the E-LOK 6-Series

(Around 5-10 meters from each or as close as possible).

**If the E-LOK Gateway is not near one or both, connection may be poor and the E-LOK Gateway may not function as expected.**

### Gateway Specs:

Network: 2.4 GHz

IEEE Standard: 802.11b/g/n

Power Interface: Type-C USB

Power Input: DC5V/500mA

### Gateway Setup:

Open the App menu, select 'Gateway'. Select '+' Sign. Select Gateway type ex. G2 (Wi-Fi).

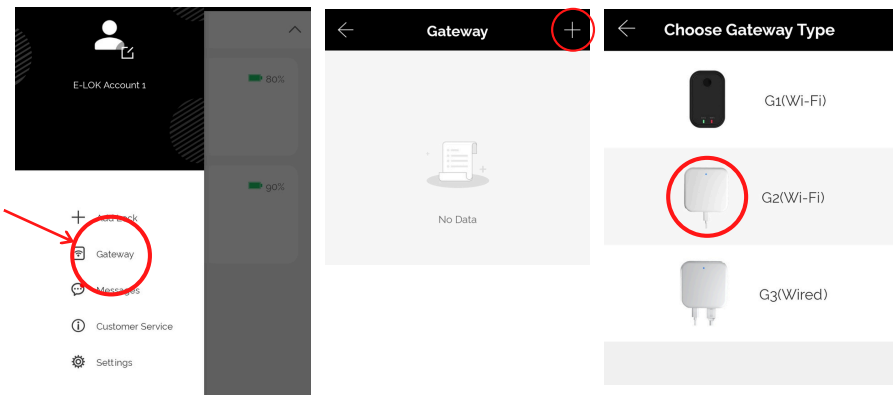

## E-LOK Gateway Setup Continued (Optional Add-On)

### Sync Gateway to E-LOK App:

Plug in the E-LOK Gateway. The light should flash red and blue - ready to connect.

Select 'Next' then Select the gateway you want to add (at the top in bold). Configure your network (2.4GHz only). Select the Wi-Fi network and input Wi-Fi password. Name the E-LOK Gateway.

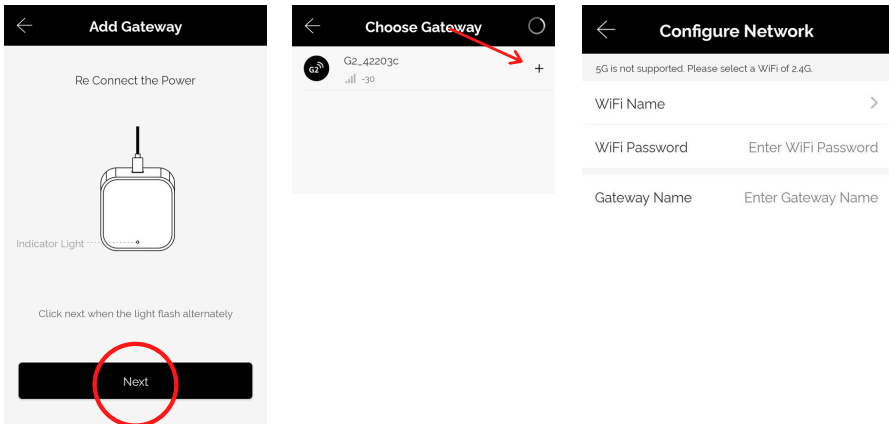

### Connect E-LOK to Gateway:

The E-LOK Gateway will now scan for an E-LOK's to connect to. You can have multiple E-LOK's connected to one E-LOK Gateway. To connect an E-LOK go to the App menu, select 'Gateway', select the gateway you want to connect to. Select the lock(s) you would like to connect to.

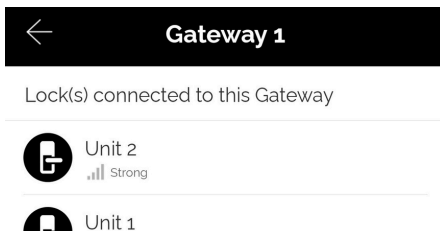

If the E-LOK Gateway refuses to connect or displays an error messages; disconnect it from the power source for at least 15 minutes. Then retry setting it up.

## Remote Unlock + Power Saving Mode

### Remote Wi-Fi Unlock (only with E-LOK Gateway).

After you've connected your phone to your E-LOK Smart Lock and connected your E-LOK Gateway, open the lock management page, select 'Settings', and enable 'Unlock Remotely'. Now select the 'lock' icon, this will unlock your E-LOK via Wi-Fi. If Auto Lock is on in the E-LOK settings, it will lock automatically. Otherwise you can hold down the 'lock' button to lock it remotely.

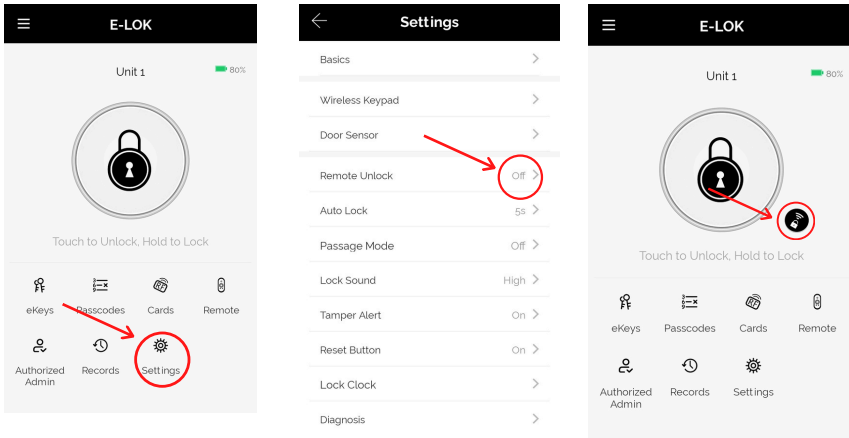

### Power Saving Mode and Wi-Fi

This feature allows your E-LOK to conserve power by only connecting via Wi-Fi when reporting to the Master Admin. To control the E-LOK via Wi-Fi Power Saving Mode needs deactivated. Open the lock management page and select 'Settings', select 'Remote Unlock', then 'WiFi'. Select 'Power Saving Mode' and choose your preferred setting.

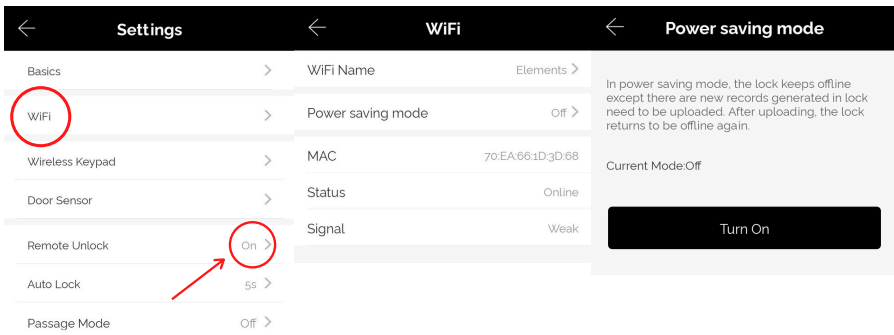

## E-LOK Gateway Reset + Transfer (Optional Add-On)

### Reset E-LOK Gateway:

Go to the E-LOK App menu, select 'Gateway'. Select the Gateway you would like to factory Reset and select 'Delete'. This will un-sync the Smart Locks that are connected to it. The Smart Locks will work as usual via Bluetooth.

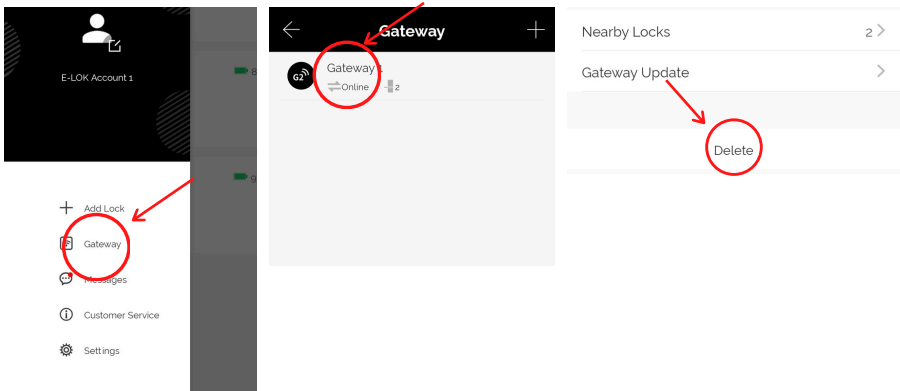

### Transfer E-LOK Gateway:

Go to the E-LOK App menu, select 'Settings'. Select 'Transfer Gateway' and select the gateway you would like to transfer. Enter the receiver's phone number or email (**whichever their E-LOK App account is setup under**) and select 'Next'.

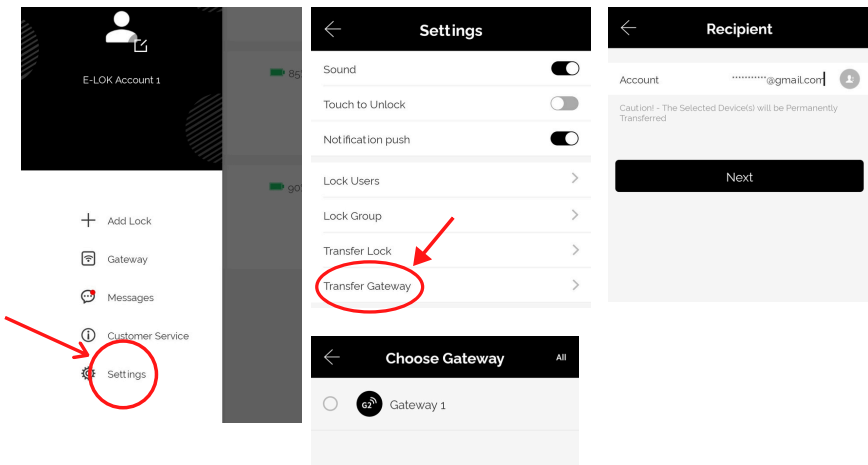



## E-LOK Maintenance Guidelines

Maintenance should be carried out on your E-LOK 6-Series every 6 months.

Use the below guide to ensure your E-LOK Smart Lock lasts the test of time:

### Every 6 months:

- Check that the screws fixing the mortice lock are tight. Check that the screws fixing the rear panel to the front panel are tight.
- Check if batteries need replacing. If battery percentage is low replace with four fresh Alkaline 1.5V AA batteries. When replacing the batteries, they are located on the inside, under the plastic cover. You slide the whole plastic cover up off the interior side to access the batteries. See below the ways the batteries need to be put in.



- Wipe the surface of the E-LOK 6-Series Smart Lock with a cloth dampened with only water. This will help remove any dust or micro contaminants from the surface.
- It is also a good idea to do a full Manual Factory Reset of the E-LOK 6-Series Smart Lock to ensure software stays light and un-bloated.

## Important Notes + Contact Us

### Important Notes:

E-LOK's have very limited features until an administrator (Master Admin) is setup using the E-LOK App.

**To download the App scan the QR code below:**



- Default Code: (123456✓)
- Initialization Code: (000✓)
- Manual Passage Mode: (123✓) while unlocked.
- Lock E-LOK (Hold ) or (Hold App Lock button)

The E-LOK App works with the complete range of E-LOK smart locks and Gateways.

The E-LOK App allows you to manage multiple E-LOKs smart locks and Gateways, name your E-LOKs and Gateways during setup to prevent mix ups.

The E-LOK Gateway can connect to multiple E-LOK smart locks within range (5-10m).

Remove all protective coverings after installation to prevent plastic deterioration causing surface damage.

**Contact us by visiting [e-lok.com](http://e-lok.com)**



**or find our contact details on the E-LOK App 'Customer Service' page.**

**Notes:**

# ELOK

## 6 - Series

### User Manual

Scan to download the E-LOK App

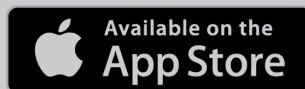

E-LOK.com

