

ELOK

805 & 805W User Manual



Summary Check List:

For further details see pages 8-12

☐ 1. Crop out done as per template.

☐ 2. Arrow on spindle hub points down.

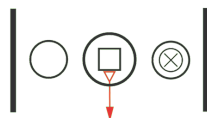

Point clutch arrow down;
Change handing, release screw beside clutch
+ turn lever.

☐ 3. Check rubber gasket installed correctly with lugs pressed in tight. So proper seal around backplate edge is created.

☐ 4. Ensure split pin is installed, or sprung spindle pin is seated correctly, securing spindle to spindle hub.

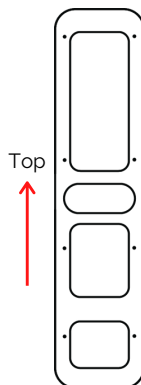

☐ 5. Ensure screw casing bolts and through bolts tightened.

☐ 6. Ensure power cable wire installed correctly and not bent or crimped in door.

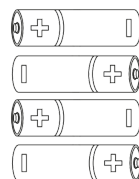

☐ 7. Check batteries installed in correct position.

Professionally Installed by: _____

PIN-Code: _____

Date: ____/____/____

Please Note:

- Keep the included mechanical keys in a convenient place such as an Elements Hardware 1236-BLK Key Safe
- Replace the batteries when they have low voltage
 - **Use Alkaline 1.5v Batteries Only**
- Read this User Manual carefully before installing your 8-Series Smart Lock



1236-BLK Shown:

Contents Page

Pg 5.	8-Series Body Dimensions
Pg 6.	Mortice Lock Options
Pg 7.	8-Series Packing List
Pg 8.	8-Series Specifications
Pg 9.	Adjusting the Handing
Pg 10.	Correct Spindle Hub Setup
Pg 11-12.	Installation
Pg 13.	Using E-LOK 8-series Smart Lock
Pg 14.	Privacy Lock
Pg 15.	Set-Up E-LOK App
Pg 16.	Connect to Wi-Fi for 805W Model
Pg 17.	Battery Percentage + Lockset Clock
Pg 18.	Bluetooth Unlock + PIN Code Management
Pg 19.	RFID Card Management + Remote
Pg 20.	Authorized Admin + e-Key Management
Pg 21.	Passage Mode
Pg 22.	Admin Passcode + Records
Pg 23.	Auto Lock + Lock Sound
Pg 24.	Import From Another Lock + Lock Groups
Pg 25.	Proximity Touch + Reset Button Control
Pg 26.	Remote Unlock + Transfer Ownership
Pg 27.	Factory Reset + Removing E-LOK from App:
Pg 28.	E-LOK Gateway Info + Setup
Pg 29.	E-LOK Gateway Setup Continued
Pg 30.	E-LOK Gateway Reset + Transfer
Pg 31.	Maintenance Guidelines
Pg 32.	Important Notes + Contact Us

8-Series Body Dimensions

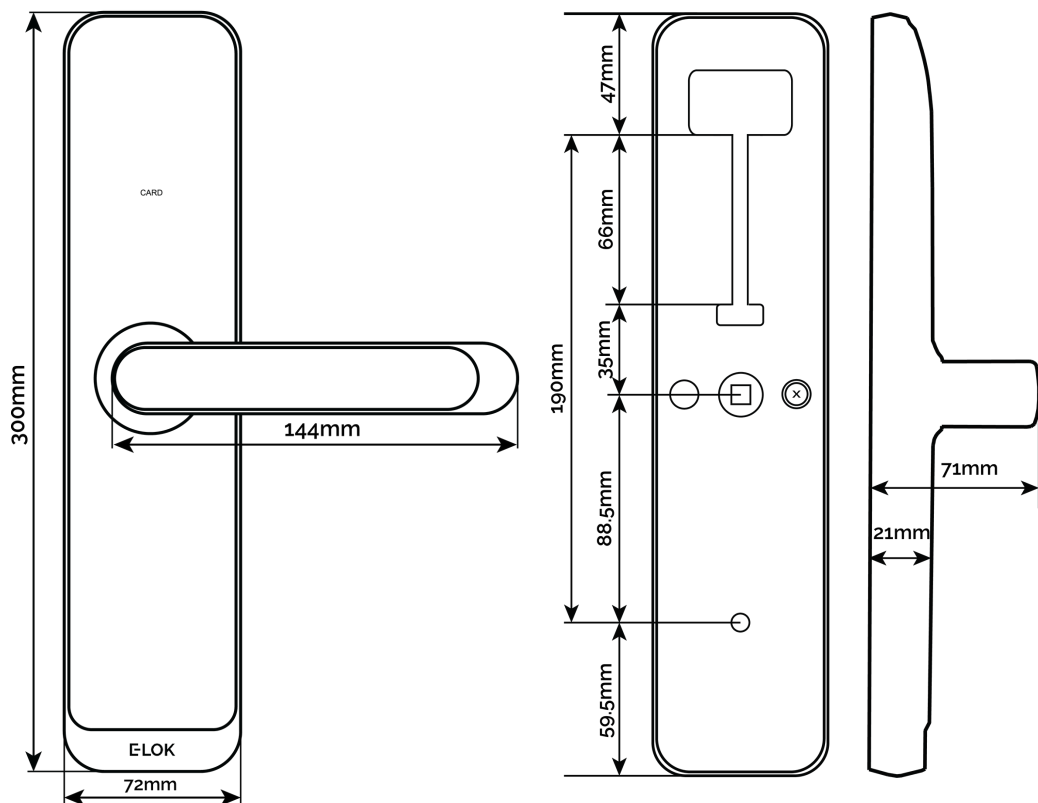

- Left, E-LOK 805 body and lever dimension
- Mid, Backplate mounting/screw points
- Right, side view body and lever projection

Common Mortice Lock Options

All Mortice templates are available online at E-LOK.com

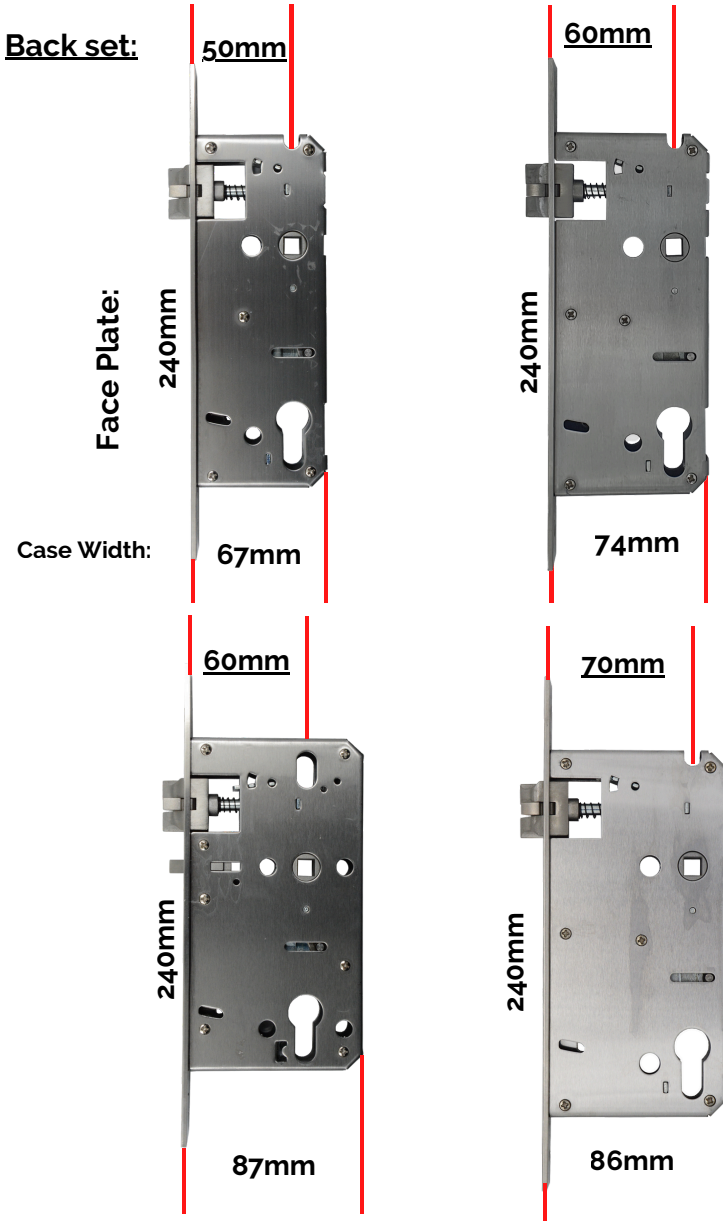

8-Series Packing List

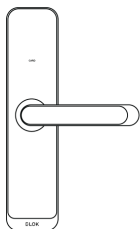

Front Panel
QTY 1

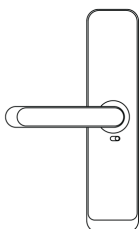

Back Panel
QTY 1

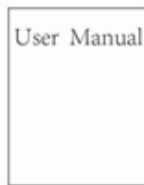

User Manual
QTY 1



Gasket
QTY 2

For door
thickness:
30-50mm



Short Spindle
QTY 1

For door
thickness:
50-70mm



Long Spindle
QTY 1



Screw Casing
QTY 2



Sliding Screw
QTY 2

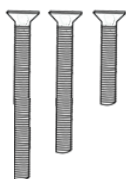

Fixing Screws 1
QTY 3



Mechanical Key
QTY 2



RFID Card
QTY 3



Mortise Fixing
Screws (Al)
QTY 2

(not included with 805-0)

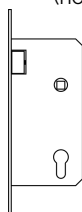

Mortise lock
QTY 1

(not included
with 805-0)



Mortise Fixing
Screw (Wood)
QTY 4



Gateway
(Optional)

Specifications

Product Name:	E-LOK 8-Series Smart Lock
Operating Application:	E-LOK App
Finish:	Black, or Silver.
Unlock Methods:	PIN Code RFID Card E-LOK App Mechanical Key
Max Num. Locks on App:	Unlimited
Max Num. PIN Codes:	200 PIN Codes
Max Num. RFID Cards:	200 RFID Cards
Batteries:	6V (4 x AA Batteries) - Must be Alkaline
Operating Temp:	— 20°C - 70°C
Operating Humidity:	10% - 95%
Suitable Door Thickness:	30mm - 70mm
Suitable Door Types:	Aluminium Door, Wooden Door
Product Size (Body only):	300mm(H) x72mm(W) x21mm(D)
Product Size (Including Lever):	300mm(H) x170mm(W) x71mm(D)
Available Mortice lock Sizes:	50mm, 55mm, 60mm, 60mm Anti-Tamper and 70mm Back Set.
8-Series Residential Warranty:	2 Year Mechanical and Electrical
E-LOK Gateway Warranty:	2 Year
Weather Rating:	Exterior Rated IP 55

Adjusting The Handing

Adjust Handing Instructions:

- Locate handing screw as shown on right:
- Un-do and remove handing screw.
- Rotate entire lever 180 degrees into opposite position.
- Re-install handing screw in opposite position (use locktite to keep screw tight)
- Test lever action, ensure both handing screw and hex lever screw is tight.

Complete this same process for the second E-LOK 8-Series panel.

Ensure handing screw is tight before moving on.

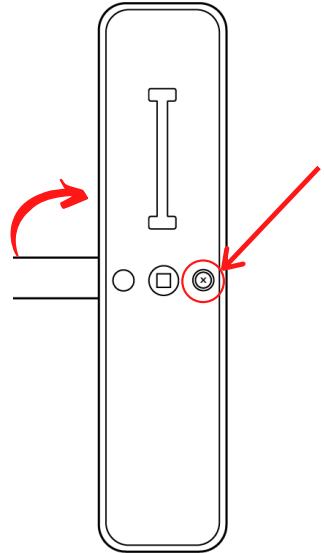

To reverse the Mortice Lock:

- Turn lock upside down
- Push latch into lock case
- Holding latch in lock case, rotate 180 degrees
- Release latch to full extended position.

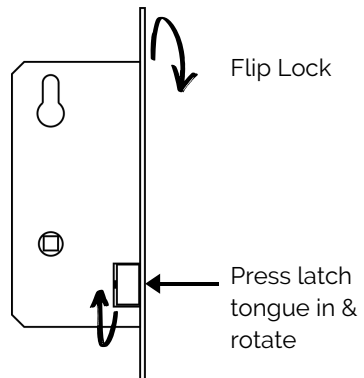

Arrow on Spindle Hub & Split Pin

The arrow on the spindle hub must be installed pointing down for the E-LOK 8-Series Smart Lock to work as designed.

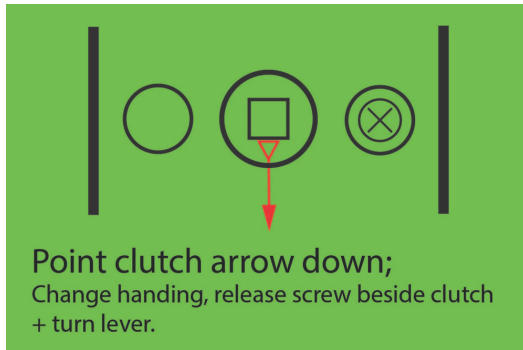

If this step is missed and the arrow is pointing:

Horizontal: Whilst outside, the deadbolt won't throw when lever is lifted up.

Upwards: The E-LOK will appear to stay unlocked permanently.

Please check the spindle hub arrow direction and the spindle is locked into place if either of the above is occurring.

If your E-LOK was working fine for 4-12 weeks and now won't open from the outside, the Split Pin may have not been installed, or Sprung Pin was not seated correctly.

To test:

Open door from inside, lift the inside handle up, check if deadbolt has thrown. Holding the outside handle, lift the outside handle up, check if deadbolt has thrown. If the deadbolt throws with the inside handle and not the outside handle, the Split Pin was not installed or Sprung Spindle is not seated correctly.

Installation

Step 1.

Using the included mortice template, cut holes into door

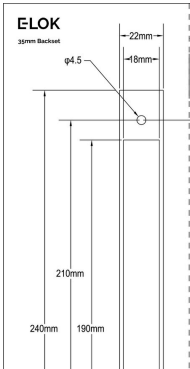

Step 2.

On the door face, drill holes to suit the fixing screws and spindle positions. (Top fixing screw is adjustable please drill to actual position)

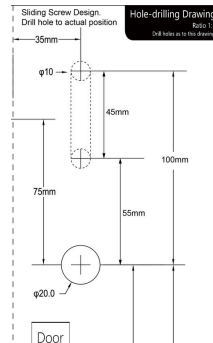

Step 3.

Install the mortice lock into the door. Ensure fixings are tight and straight.

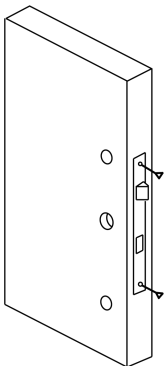

Step 4.

Install the spindle into the exterior handle. Ensuring that the spindle has locked into place and the spindle hub arrow is pointed down.

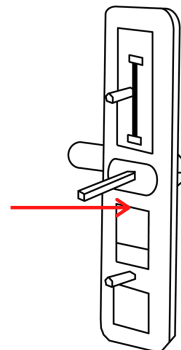

Installation

Step 5.

Fit Sliding Screw to Screw Casing, then install into adjustable screw slot on Exterior handle.

Install bottom Screw Casing to Exterior handle.

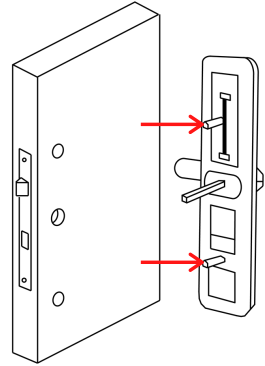

Step 6.

Attach the rubber sealing gaskets to both the Interior and Exterior handles.

Step 7.

Remove the front cover from Interior handle; using the indent at the top gently pull the cover away (it is clipped on).

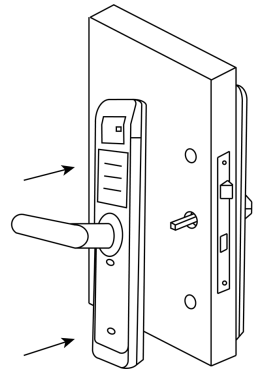

Step 8.

Ensuring there is sufficient room for cable, align Exterior handle with holes drilled and connect the Interior and Exterior handle's cables (a hole may need drilled for cable).

Step 9.

Align Interior handle with spindle and fixing holes. Fix Interior and Exterior handles together using correct sized fixing screws for the door thickness.

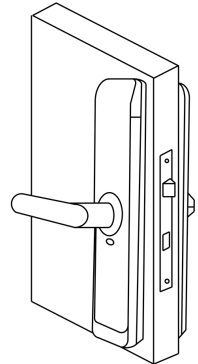

Step 10.

Install Batteries into battery case and slide the battery cover back into place.

E-LOK 8-Series Smart Lock is ready to go!

Using E-LOK 8-Series Smart Lock

Your E-LOK 8-Series Smart Lock has two handle functions:

Lift up the handle to engage the mortice deadbolt.
Pull down to unlock and release latch and deadbolt.

Important Notes:

When the E-LOK 8-Series automatically locks, the handle disengages from the latch.

Lift the handle to engage the dead bolt (this is not automatic).

The deadbolt will disengaged when the door is unlock and the handle is pulled down or the interior handle is pulled down at any time.

Using your Pin Code: enter your pin code followed by '#' to unlock your E-LOK. (default pin 123456)



Unlocking E-LOK 8-Series with Mechanical Key

Your E-LOK comes with two mechanical keys to unlock/lock your E-LOK mechanically.

Insert Mechanical Key into slot as shown. Turn key 90 degrees. Pull the handle down as it is now engaged with the latch.

The USB-C port beside it can be used to power up the Smart Lock if the batteries run flat.



Privacy Lock

Privacy Lock:

This feature allows you to enable 'Secure Lock' which means only the the Master Admin or the Manual Key can unlock the door from outside. To use this feature simply switch the privacy lock on the interior handle to Red (secured) and Green (unsecured). Please note that using the interior handle will automatically deactivate the Privacy Lock.



Privacy Lock
is off

Set-Up E-LOK App

Get the E-LOK App



The Register screen features a back arrow at the top left. Below the title, there are two tabs: 'Email' (selected) and 'Phone'. The form includes fields for 'Country/Region' (set to 'New Zealand'), 'Enter your Email', 'Password' (with a strength indicator), and 'Confirm Password'. A note specifies: 'Your password must have 8-20 characters, and include a minimum of two types of numbers, letters and symbols'. There is a 'Verification Code' field and a 'Get Code' button. At the bottom, a 'Register' button is present, along with a checkbox for 'I've read and agreed User Terms Privacy Policy'.

1. Register an account with E-LOK using either phone number or email.

The Login screen has a back arrow and a 'Register' link at the top right. The E-LOK logo is centered. Below it, there are fields for 'Phone Number or Email' and 'Password'. A checkbox for 'I've read and agreed User Terms Privacy Policy' is checked. A 'Login' button is at the bottom, with a link for 'Forgot Password?' below it.

2. Login to your account.

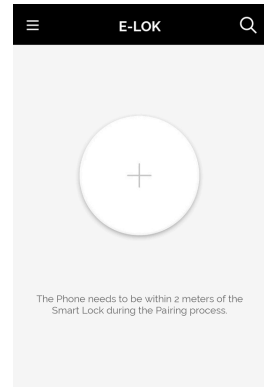

3. Ensure E-LOK smart lock is on and Bluetooth enabled on phone, connect to lock. Tap Keypad & select '+' sign to pair

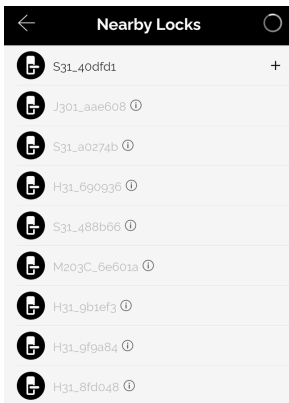

4. Select your E-LOK smart lock. Note it will appear under a serial number which is usually at the top in black.

The 'Add Lock' screen shows a message: 'PAIRED Successfully. Please ASSIGN a Name for it'. Below this is a text input field labeled 'Enter a Name'. At the bottom is an 'OK' button.

5. Rename your E-LOK smart lock to your preference.

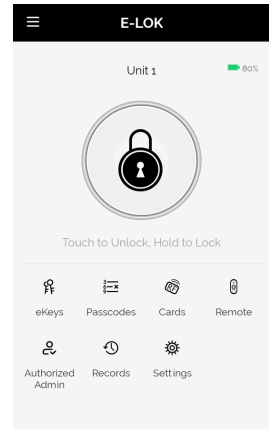

6. View your E-LOK lock management page.

Connect to WiFi: (For 805W Only)

There are two ways to connect the lock to your WiFi:

1. When you connect to the lock through the APP, you can choose to connect on the 2.4G WiFi. Follow the steps and enter your WiFi Password.
2. Or go into the lock Settings and follow the below steps
 - o 'WiFi'
 - o Choose your WiFi
 - o Choose the 2.4G
 - o Enter your Wifi Password.

Turn off the "Power Saving Mode":

Keeps Wi-Fi connected at all times, remote unlocking available, and will still send reported messages to the Master Admin. This will also be reported in the 'Records' in the E-LOK App.

Turn on "Power Saving Mode":

The Wi-Fi is connected only when a message is reported. The lock cannot be opened remotely and will only send a reported message to the Master Admin.

How to change to "Power Saving Mode"

- Settings
- Check 'Remote Unlock' is showing on (If Power Saving Mode is turned off)
- Select 'WiFi'
- Select 'Power Saving Mode'
- Choose to select on or off

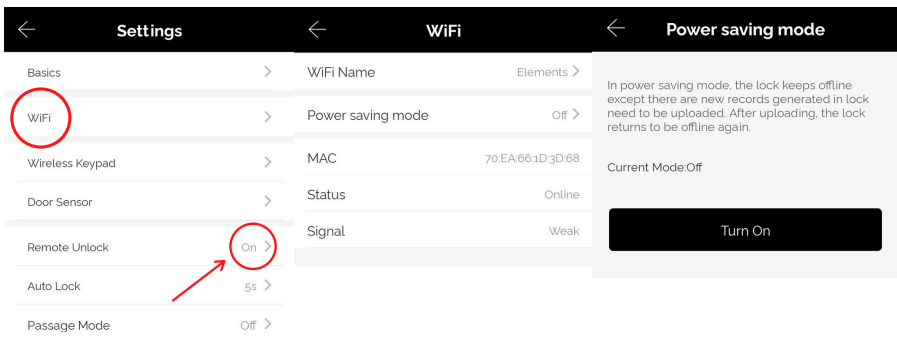

Battery Percentage + Lockset Clock

Check Battery Percentage:

E-LOK App allows you to check the battery percentage of your E-LOK in two easy ways. In the lock select page, the app will give you a percentage overview to the nearest 5%. You can also find a more accurate battery level in the settings of the Smart Lock. Select 'Settings', select 'Basics' and then view your battery percentage. **Remember to update this frequently (select 'Battery' and 'Update' while within Bluetooth range).**

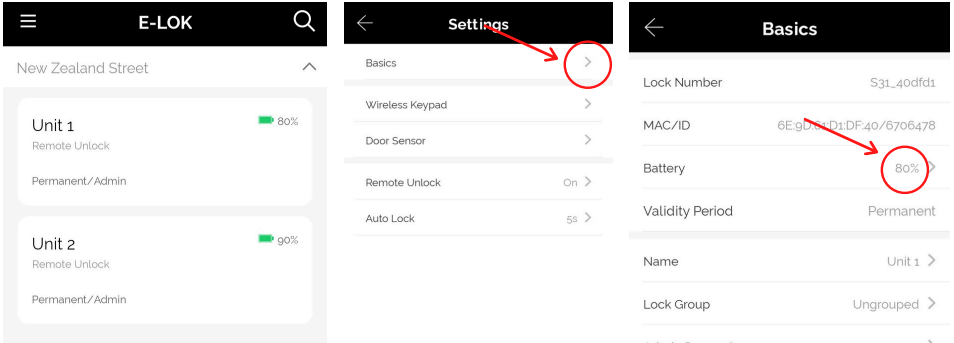

E-LOK Lockset Clock:

Celebrate you E-LOK's Lockset Clock. Select 'Settings' then 'Lock Clock'. Select 'Calibrate Time'. Your E-LOK Smart Lock will communicate with the E-LOK App and set the correct time. This will ensure that operation specifications and unlock records are accurate.

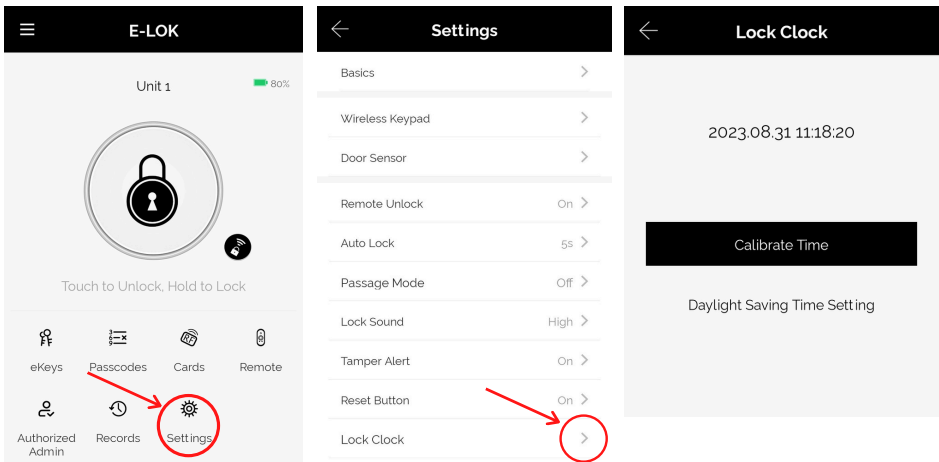

Bluetooth Unlock + PIN Code Management

Bluetooth Unlock:

Once the E-LOK is connected to the App you can Lock and unlock the E-LOK using the App. Open the lock management page and select the 'lock' icon, this will unlock your Smart Lock via Bluetooth. Hold the 'lock' icon and your smart lock will lock via Bluetooth.

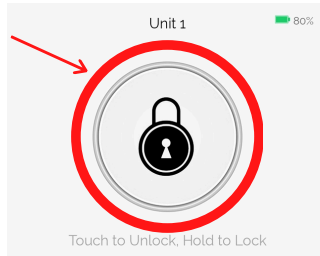

PIN Code Management:

E-LOK App allows you to set 200 unique PIN Codes. You can set a range of different types of PIN Code. We recommend using the 'Custom' setting to create yours. Set it to permanent, name it and set your preferred sequence. (4-9 digits).

Recurring PIN Code allows you to set a PIN Code that only works on certain times and days ex. Saturday and Sunday from 10:00 - 20:00. The app also allows for one-timed and timed PIN Codes. For security reasons codes will time out if not used within a specified period - see the App for more details.

Using your Pin Code: enter your pin code followed by '#' to unlock your E-LOK. E-LOKs have an inbuilt security function which allows for additional numbers to be entered as long as your pin is entered in sequence, ex. pin '1234' entered '5612348'.

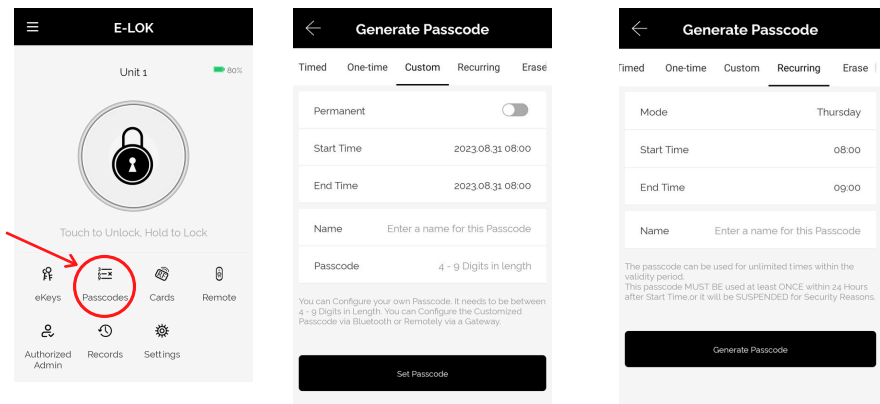

RFID Card Management + Remote

RFID Card Management:

E-LOK App allows you to store 200 unique RFID Cards. To set up one of the three FOBs included with your E-LOK 8-Series Smart Lock, select 'Cards' on the lock management page, select 'Add Card'. Choose Timed, Permanent, or Recurring, and name them individually.

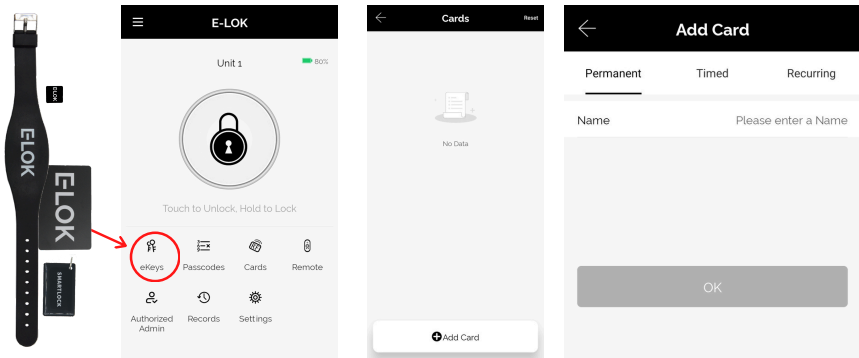

E-LOK Remote:

E-LOK's have a function where you can connect a remote to the lock, so you can unlock and lock it via bluetooth.

First, go to 'Remote', on the E-LOK management page. Next choose permanent, timed, or recurring. Then, select 'add remote'. Follow the instructions on the screen to add the remote to your E-LOK.

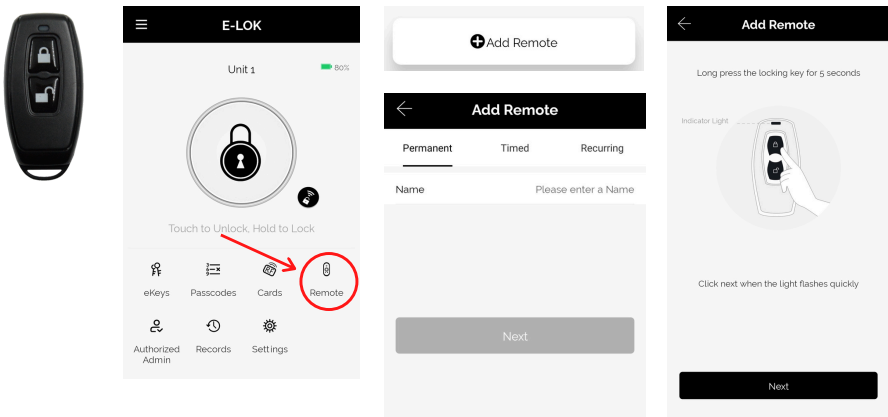

Authorized Admin + e-Key Management

Authorized Admin:

Authorized Admin allows another person with an E-LOK App to access your E-LOK, they can add, change or delete unlock codes set by themselves. Select 'Authorized Admin' in the E-LOK management home page. Then Select 'create admin', **Please note: Send this to the phone number or email associated with the receivers E-LOK App account.**

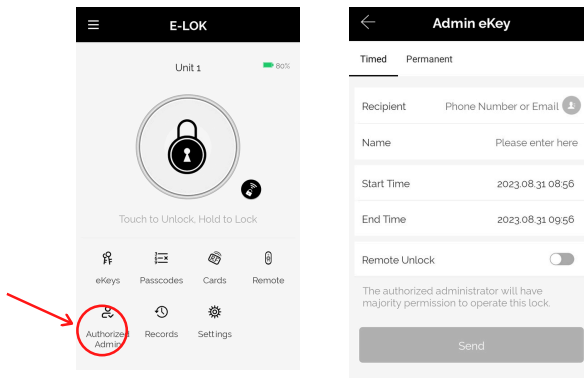

e-Key Management:

An e-Key allows another person with an E-LOK App to unlock/lock your E-LOK 8-Series via the App; e-Keys can be setup as permanent or with parameters. Select the 'eKeys' on the lock management page. Then select 'send eKey'. **Please note: Send this to the phone number or email associated with the receivers E-LOK App account.**

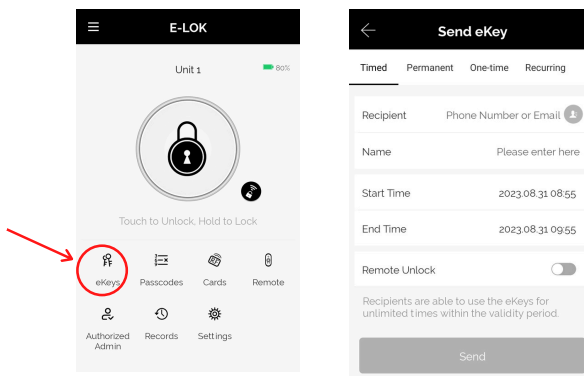

Passage Mode:

Passage Mode:

Set parameters to keep the E-LOK unlocked during specified periods. Select 'Settings', Select 'Passage Mode', Choose the days and hours you wish the E-LOK to be open (ex. Mon - Fri 9:00 - 17:00). From when it is unlock electronically during these hours your E-LOK will say unlocked. The 'Auto Lock' function will lock the E-LOK at the specified time.

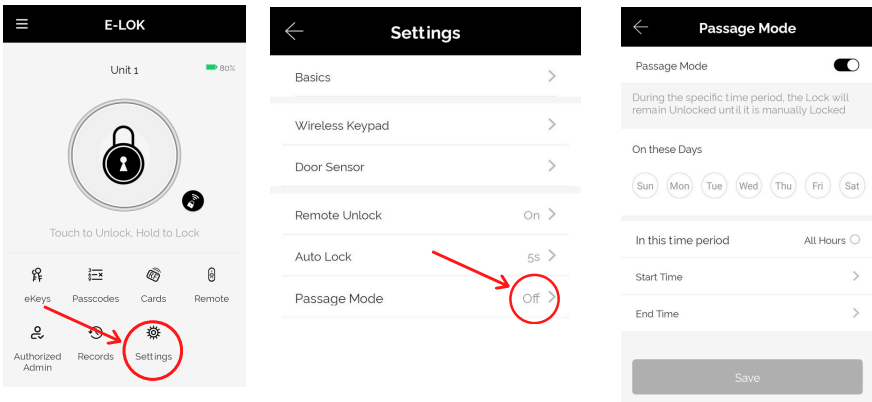

Manual Passage Mode:

E-LOK's can be put into Passage Mode manually by unlocking the E-LOK using pin number etc. then entering '123#' on the Keypad.

Locking your E-LOK in Passage Mode:

Method 1.

Open up the E-LOK App, long press 'Lock' button on E-LOK app. And lift the handle to engage the deadbolt

Method 2.

Once exited, long press '#' Key on pinpad. And lift handle to engage bolt.

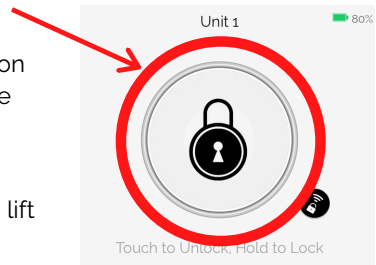

Admin Passcode + Records

Admin Passcode:

E-LOK comes with an admin passcode. To view this select 'Settings' on the lock management page, select 'Basics' and then select 'Admin Passcode'.

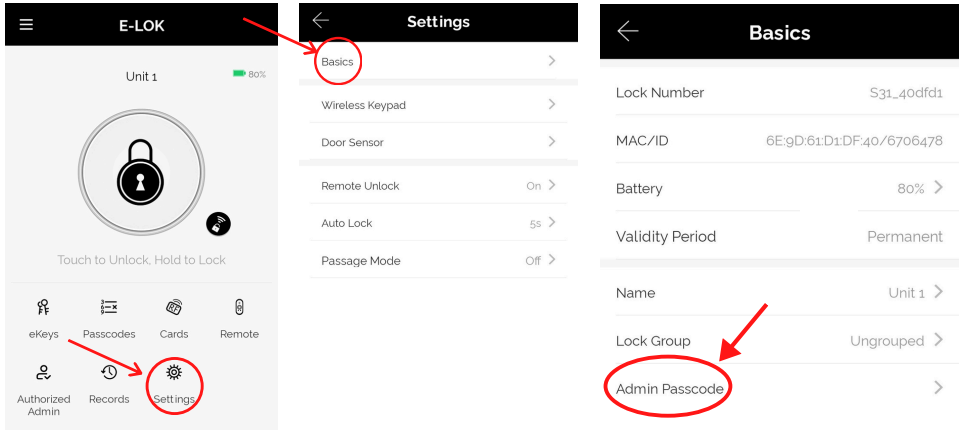

Unlock Records:

E-LOK App records which passcodes were used to unlock and lock the E-LOK and when. You can view these records by going into the 'Records' menu on the lock management page. Only a certain period of records can be retained, you can export these to a spreadsheet to keep historical records and clear or refresh your records to keep things current.

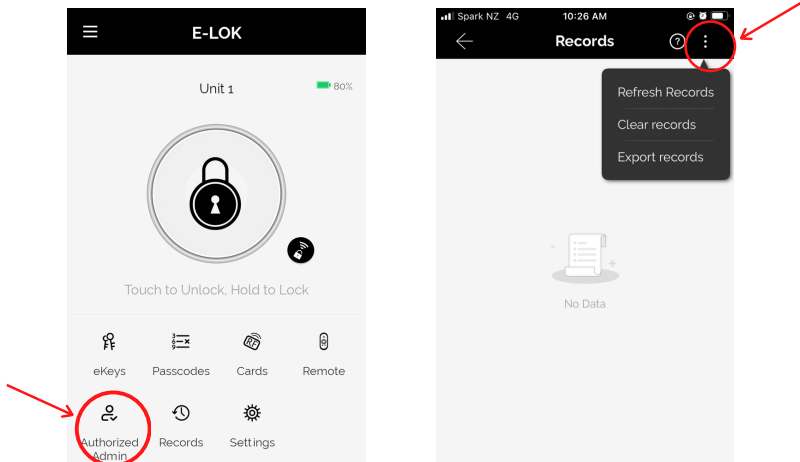

Auto Lock + Lock Sound

Auto Lock:

This function automatically disengages the exterior handle. The E-LOK App allows you to control the auto lock timer on the Smart Lock, you can adjust the time allowed or turn this function off. Select 'Settings'. Select 'Auto Lock'. Adjust setting to suit. **Please note if Auto Lock is off Passage Mode will not lock automatically.**

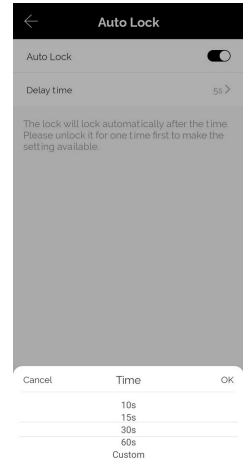
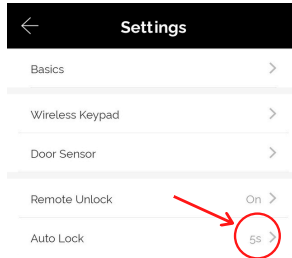
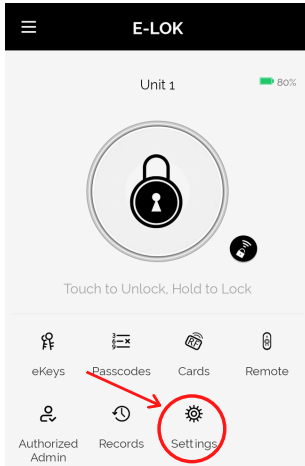

Lock Sound:

The Lock Sound function lets you enable or disable the sound and control the volume. By default Lock Sound is enabled and on high. Select 'Settings'. Select 'Lock Sound'.

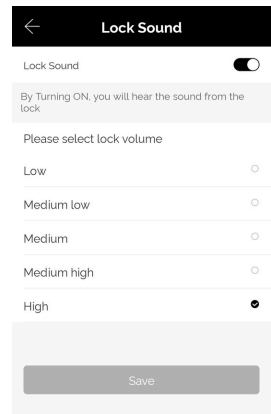
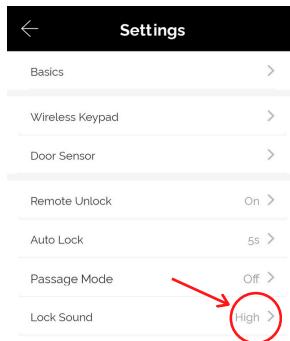
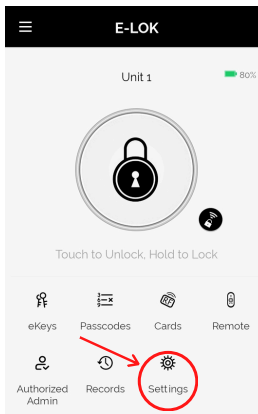

Import From Another Lock + Lock Groups

Import from another E-LOK Smart Lock:

This feature allows you to sync PIN-Codes and RFID Cards between E-LOK Smart locks. Select 'Settings'. Select 'Import from another lock'. Select the lock you would like to import from.

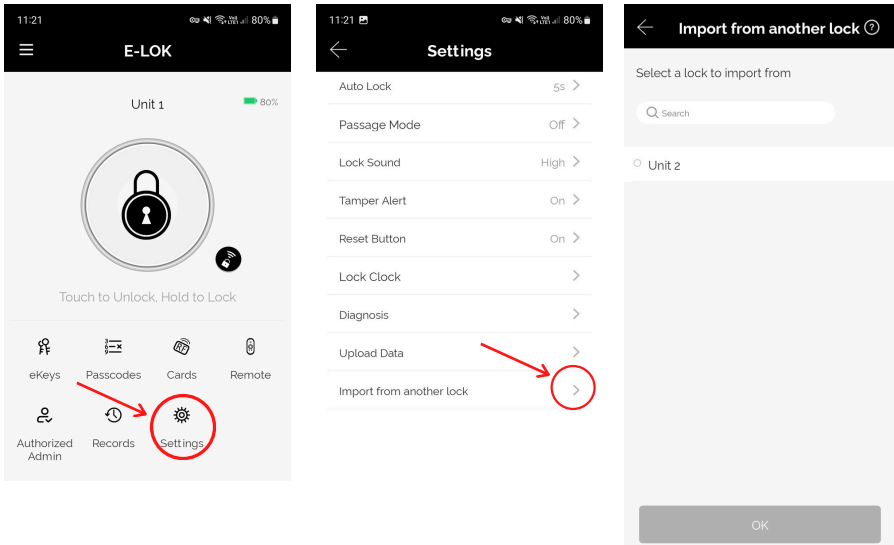

Lock Groups:

You can link E-LOK Smart Locks together in lock groups. First create a lock group in the main settings, then link a Smart Lock to the group in each individual lock settings, select 'Settings' - 'Basics' - 'Lock Group'. View lock groups in the select page. This function allows you to keep the App's home screen tidy by grouping locks from the same site etc.

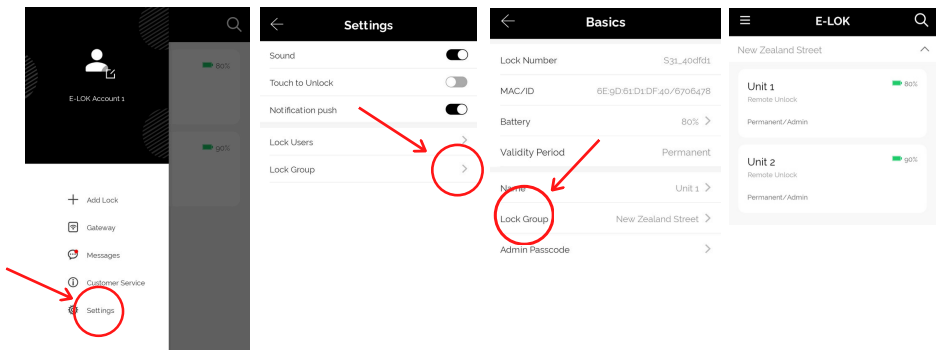

Proximity Touch + Reset Button Control

Proximity Touch to Unlock:

When this feature is enabled it lets you unlock your E-LOK Smart Lock just by pressing any number on the Keypad whilst the app is open. To use this feature, go to the App menu and select 'Settings'. Then enable 'Touch to Unlock'.

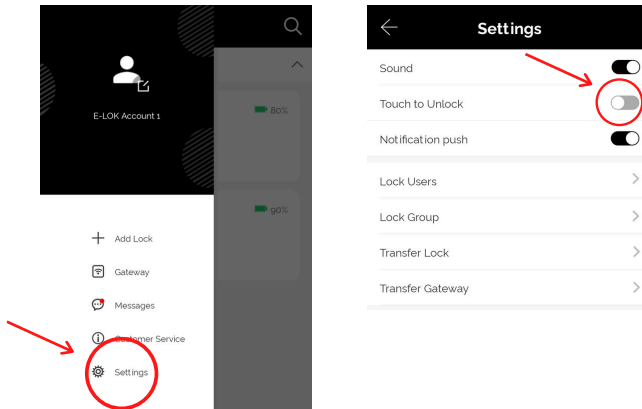

Reset Button Control:

You can disable the Manual Reset button on your E-LOK by deselecting 'Reset Button' in the E-LOK's App settings. Select 'Settings'. Select 'Reset Button'. Adjust setting to preference. This feature works great on E-LOK's installed on Airbnb's, rentals etc. **Please note that while disabled only the E-LOK's 'Master Admin' can factory reset the lock.**

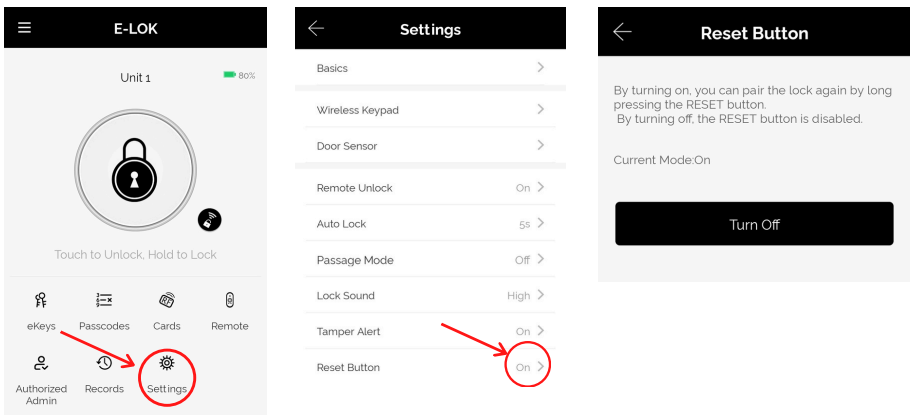

Remote Unlock + Transfer Ownership

Remote Wi-Fi Unlock (only with E-LOK Gateway Add-on or inbuilt Wi-Fi).

After you've connected your phone to your E-LOK Smart Lock and connected your E-LOK Gateway, open the lock management page, select 'Settings', and enable 'Unlock Remotely'. Now select the 'lock' icon, this will unlock your E-LOK via Wi-Fi. If Auto Lock is on in the E-LOK settings, it will lock automatically. Otherwise you can hold down the 'lock' button to lock it remotely.

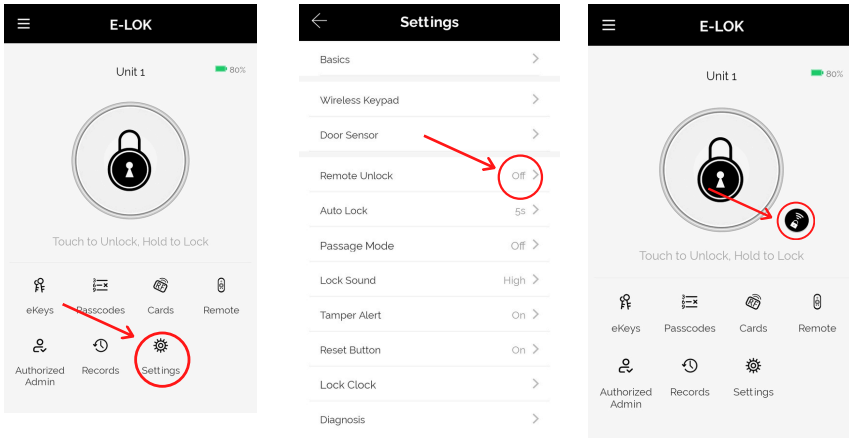

Transfer Lockset Ownership:

This feature allows the 'Master Admin' to be transferred to another E-LOK App account holder, along with all the settings, pins etc. saved to that E-LOK. To Transfer Ownership open App menu, select 'Settings'. select 'Transfer Lock'. Select the lock you want to transfer. Enter the receivers phone number or email (**whichever their E-LOK App account is setup under**) and select 'Next'.

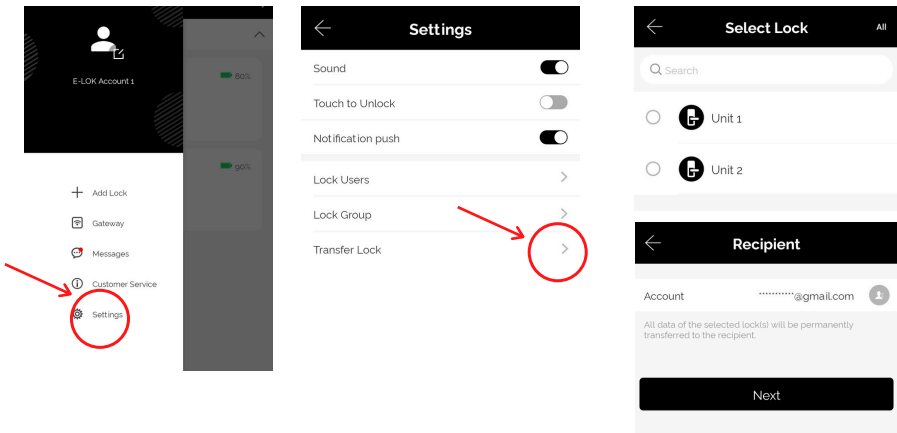

Factory Reset + Removing E-LOK from App

Factory Reset via E-LOK App: (Master Admin only)

In the lock Management Page and within Bluetooth range of the E-LOK, Select 'Settings'. Select 'Delete' and input your E-LOK App password. The E-LOK is now Factory Reset.

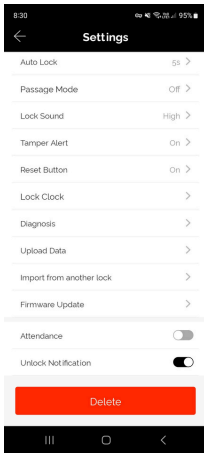

Manual Reset:

Remove battery cover and hold the reset button in the battery case until you hear "Please input initialization passcode". Input code '000#' on the keypad. E-LOK will then state "Deleting administrator successful".

Please Note: if the 'Reset Button' has been deactivated the E-LOK cannot be 'Manual Reset'.



Removing Manual Reset/Replaced E-LOKs from App:

To remove reset locks from the E-LOK app, go to the app menu, select 'Settings'. Select 'Transfer Lock(s)', select lock. Select 'Next', select 'Remove the Malfunction lock' at the bottom of the page.

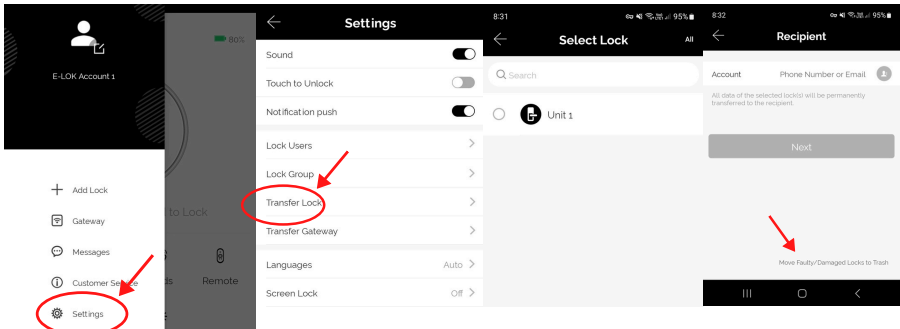

E-LOK Gateway Info + Setup

(Optional Add-On)

The E-LOK Gateway connects your E-LOK to Wi-Fi via Bluetooth, allowing the transfer of information and commands to your E-LOK via Wi-Fi.

Please note: only the **'Master Admin'** can set-up an E-LOK Gateway to a Smart Lock.

E-LOK Gateway should be plugged in via the included USB-C cable.

It must be:

- Near a Wi-Fi router
- Near the E-LOK 8-Series

(Around 5-10 meters from each or as close as possible).

If the E-LOK Gateway is not near one or both, connection may be poor and the E-LOK Gateway may not function as expected.

Gateway Specs:

Network: 2.4 GHz

IEEE Standard: 802.11b/g/n

Power Interface: Type-C USB

Power Input: DC5V/500mA

Gateway Setup:

Open the App menu, select 'Gateway'. Select '+' Sign. Select Gateway type ex. G2 (Wi-Fi).

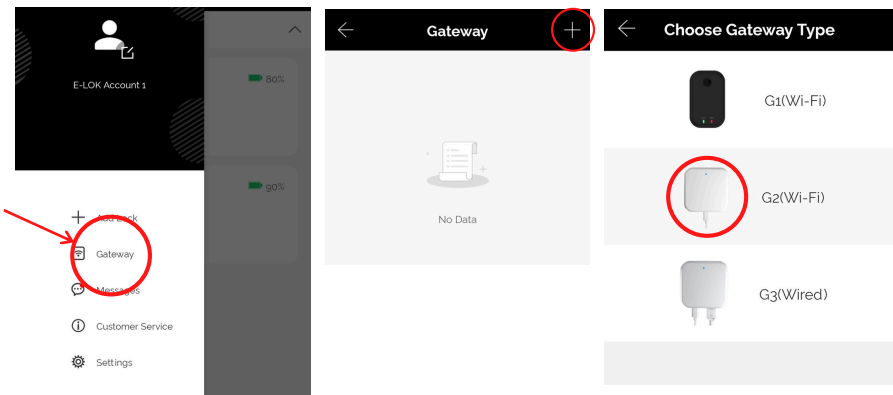

E-LOK Gateway Setup Continued (Optional Add-On)

Sync Gateway to E-LOK App:

Plug in the E-LOK Gateway. The light should flash red and blue - ready to connect.

Select 'Next' then Select the gateway you want to add (at the top in bold). Configure your network (2.4GHz only). Select the Wi-Fi network and input Wi-Fi password. Name the E-LOK Gateway.

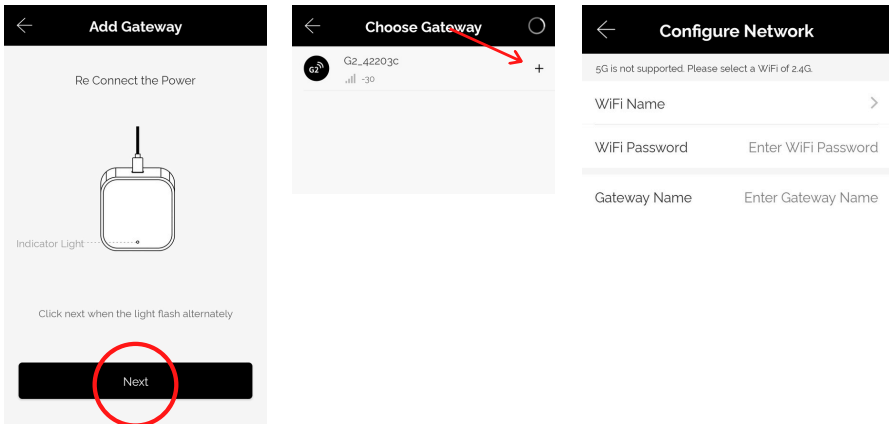

Connect E-LOK to Gateway:

The E-LOK Gateway will now scan for an E-LOK's to connect to. You can have multiple E-LOK's connected to one E-LOK Gateway. To connect an E-LOK go to the App menu, select 'Gateway', select the gateway you want to connect to. Select the lock(s) you would like to connect to.

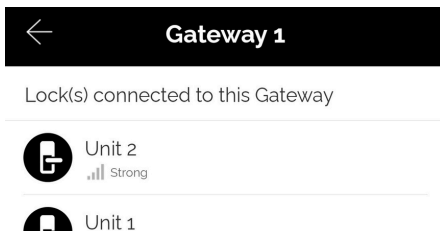

If the E-LOK Gateway refuses to connect or displays an error messages; disconnect it from the power source for at least 15 minutes. Then retry setting it up.

E-LOK Gateway Reset + Transfer (Optional Add-On)

Reset E-LOK Gateway:

Go to the E-LOK App menu, select 'Gateway'. Select the Gateway you would like to factory Reset and select 'Delete'. This will un-sync the Smart Locks that are connected to it. The Smart Locks will work as usual via Bluetooth.

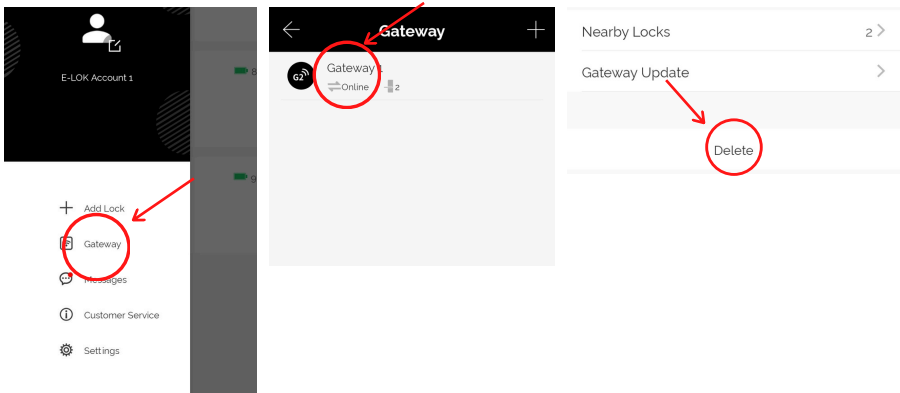

Transfer E-LOK Gateway:

Go to the E-LOK App menu, select 'Settings'. Select 'Transfer Gateway' and select the gateway you would like to transfer. Enter the receiver's phone number or email (**whichever their E-LOK App account is setup under**) and select 'Next'.

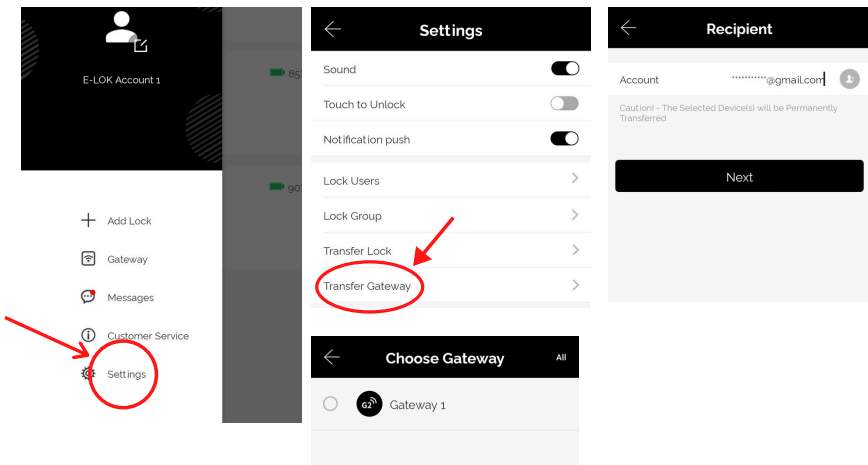

E-LOK Maintenance Guidelines

Maintenance should be carried out on your E-LOK 8-Series every 6 months.

Use the below guide to ensure your E-LOK Smart Lock lasts the test of time:

Every 6 months:

- Check that the screws fixing the mortice lock are tight. Check that the screws fixing the rear panel to the front panel are tight.
- Check if batteries need replacing. If battery percentage is low replace with four fresh Alkaline 1.5V AA batteries. When replacing the Battery's They are located on the inside, under the plastic cover. You unclip the whole plastic cover (Circled below where you can start unclipping the back) which will reveal the batteries. See below the ways the batteries need to be put in.



- Wipe the surface of the E-LOK 8-Series Smart Lock with a cloth dampened with only water. This will help remove any dust or micro contaminants from the surface.
- If the handle feels loose or wriggles from the Smart Lock, you may have to remove the Smart Lock from the door and re-tighten the inner screw with Loctite securing the handle to either or both the front and rear panel.
- It is also a good idea to do a full Manual Factory Reset of the E-LOK 8-Series Smart Lock to ensure software stays light and un-bloated.

Important Notes + Contact Us

Important Notes:

E-LOK's have very limited features until an administrator (Master Admin) is setup using the E-LOK App.

To download the App scan the QR code below:



- Default Code: (123456#)
- Initialization Code: (000#)
- Manual Passage Mode: (123#) while unlocked.
- Lock E-LOK (Hold #) or (Hold App Lock button)

The E-LOK App works with the complete range of E-LOK smart locks and Gateways.

The E-LOK App allows you to manage multiple E-LOKs smart locks and Gateways, name your E-LOKs and Gateways during setup to prevent mix ups.

The E-LOK Gateway can connect to multiple E-LOK smart locks within range (5-10m).

Remove all protective coverings after installation to prevent plastic deterioration causing surface damage.

Contact us by visiting e-lok.com



or find our contact details on the E-LOK App 'Customer Service' page.

Notes:

Notes:

Notes:

ELOK

8 - Series

User Manual

Scan to download the E-LOK App

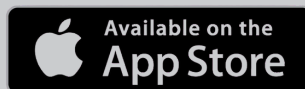

E-LOK.com

